

# Single Glass Shelf Caddy

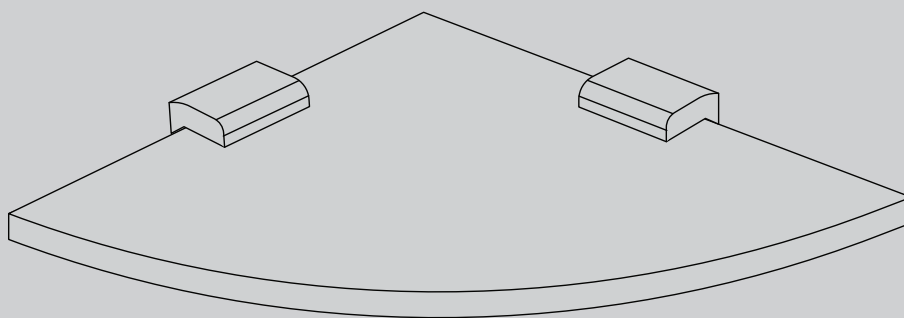

## Important

1. When you receive your Newline shower, check contents for any freight damage.
2. Advise Newline on 0508 639 5463 if any damage has occurred or a defect identified within 8 hours of receiving the goods so this can be rectified.
3. Do not proceed with installation until resolved.

## INSTALLATION

## Single Glass Shelf Caddy

1

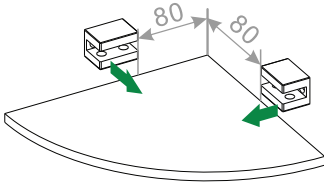

2

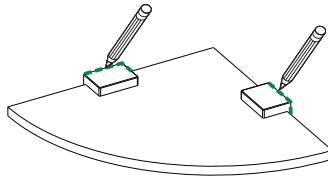

3

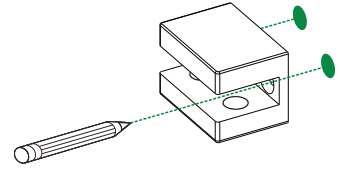

4

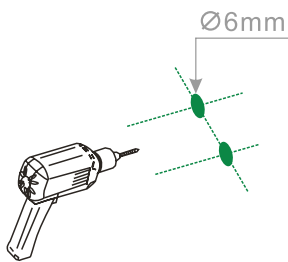

5



6

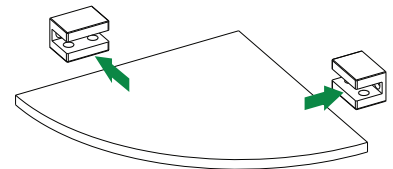

7

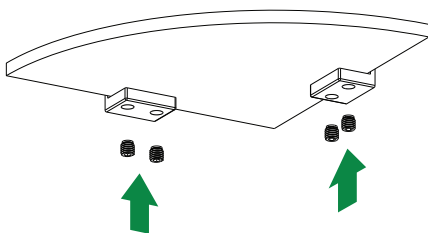

8

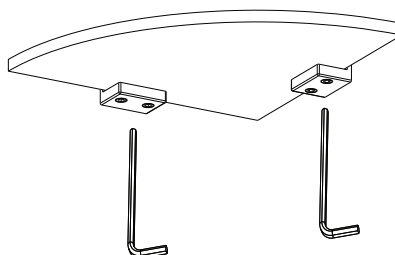

## CONTACT

**NEWLINE**  
*for a lifetime!*

54 Unutoto Place, Tauriko, Tauranga, 3171

Freephone: 0508 639 5463 Phone: 09 444 2053

Email: [info@newline.co.nz](mailto:info@newline.co.nz)

[newline.nz](http://newline.nz)

## 2-Tier Glass Shelf Caddy

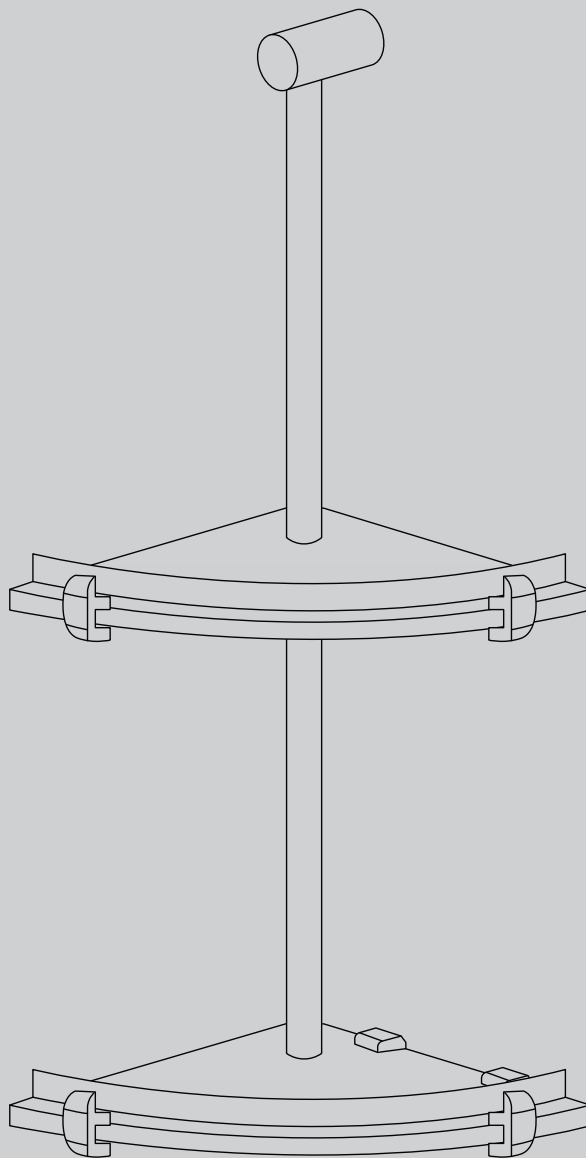

### Important

1. When you receive your Newline shower, check contents for any freight damage.
2. Advise Newline on 0508 639 5463 if any damage has occurred or a defect identified within 8 hours of receiving the goods so this can be rectified.
3. Do not proceed with installation until resolved.

## INSTALLATION

## 2-Tier Glass Shelf Caddy

1

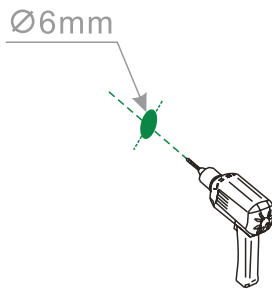

2

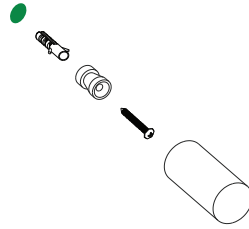

3

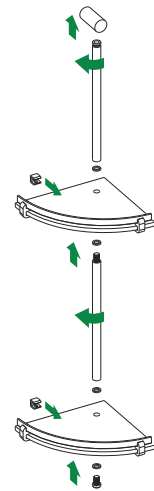

4

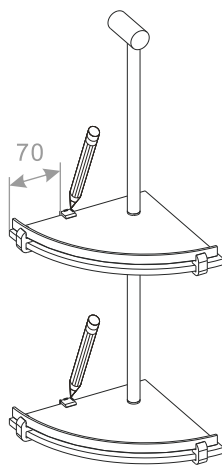

5

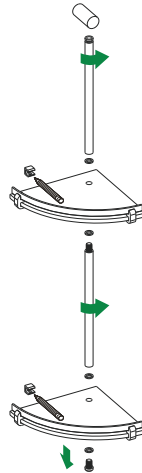

6

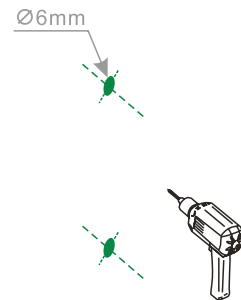

7

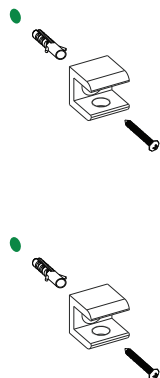

8

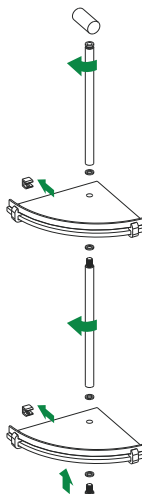

9

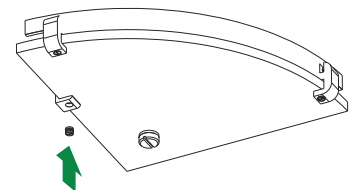

## CONTACT

**NEWLINE**  
*for a lifetime!*

54 Unutoto Place, Tauriko, Tauranga, 3171

Freephone: 0508 639 5463 Phone: 09 444 2053

Email: [info@newline.co.nz](mailto:info@newline.co.nz)

[newline.nz](http://newline.nz)



## 3-Tier Glass Shelf Caddy

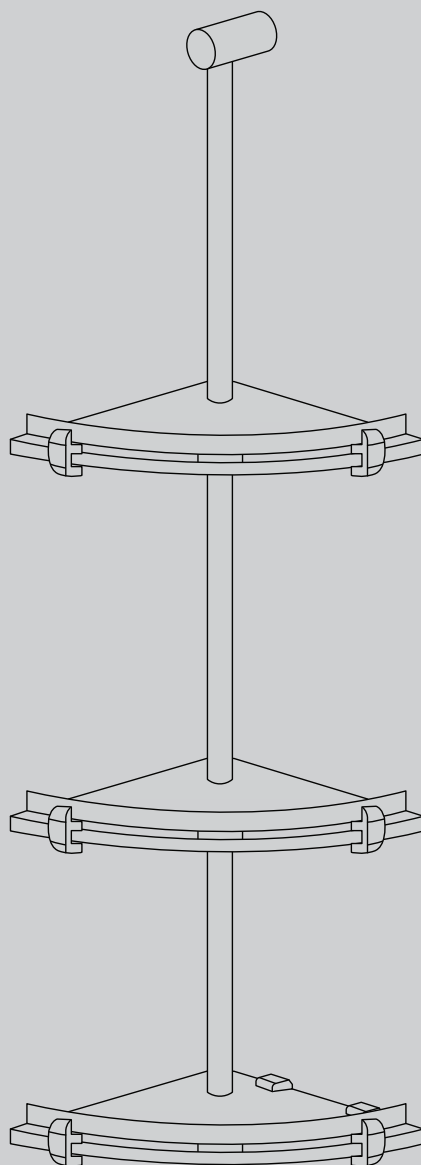

### Important

1. When you receive your Newline shower, check contents for any freight damage.
2. Advise Newline on 0508 639 5463 if any damage has occurred or a defect identified within 8 hours of receiving the goods so this can be rectified.
3. Do not proceed with installation until resolved.

## INSTALLATION

## 3-Tier Glass Shelf Caddy

1

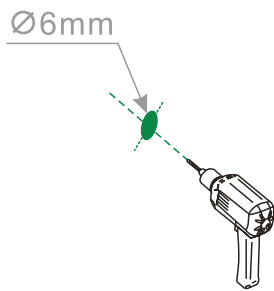

2

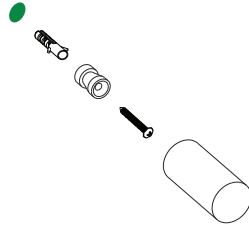

3

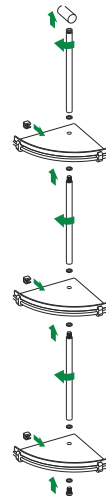

4

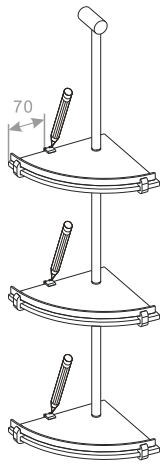

5

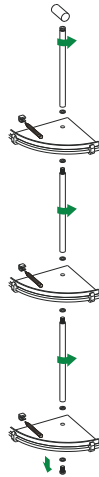

6

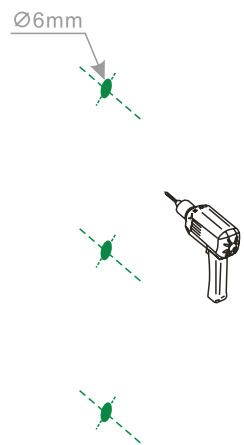

7

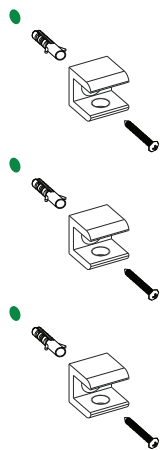

8

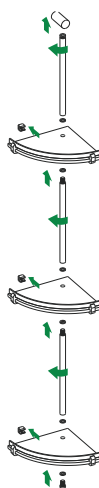

9

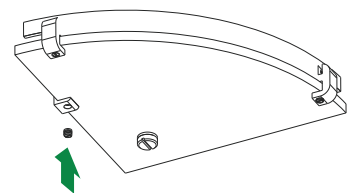

## CONTACT

**NEWLINE**  
*for a lifetime!*

54 Unutoto Place, Tauriko, Tauranga, 3171

Freephone: 0508 639 5463 Phone: 09 444 2053

Email: [info@newline.co.nz](mailto:info@newline.co.nz)

[newline.nz](http://newline.nz)

## Glass Shelf to Tiled Wall



Firstly, clean the tile surface to remove all tiling or related trade residues with Isopropyl or Meths.

The picture shows the Glass Shelf is located to the horizontal grout lines. If this is not a suitable height, added cleaning is essential for a good bond.

### There are two different support methods that can be used:

1. Two horizontal lengths of 12x12mm timber moulding strips the length of shelf edge, attach to tile with double sided tape (Example 1)
2. Two vertical pieces of timber each side of shelf that have a point facing upwards and attached with double sided tape (Example 2).
3. The aim is to temporarily hold the glass shelf level until adhesive is cured.

### Bonding and Finishing

Use Bostik V60 structural silicone, run a bead on the grout line sufficient to have some excess at the top when glass is pushed in.

Finish the silicone with soapy water and a spatula on the top and ends. Leave for 24hrs.

Note: The second support system will allow for some silicone clean up underneath.

### Complete Silicone on Day 2

Remove supports, clean off excess residues underneath and run a silicone bead to finish off.

DO NOT USE SHELVES FOR 2 DAYS (At 25 degrees C).

0224

### CONTACT