

Channel Drain | Tile



PRODUCT FEATURES

- Slimline Design
- High Quality 316 Marine Grade Stainless Steel
- Fast Water Drainage
- Designed for everyday living, with easy access and maintenance
- Suits Newline ProFinish Tile Tray System

FINISHES AVAILABLE



Black

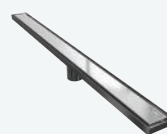

Chrome



Tile Insert

SPECIFICATIONS

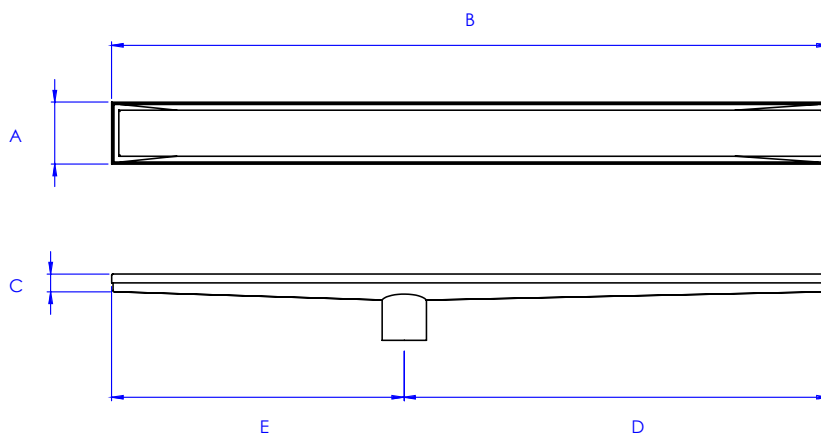

CHROME	BLACK		A	B	C	D	E
CHA0728	CHA0803	Newline Channel Kit 710*70*20	70	710	23	430	280
CHA0735	CHA0810	Newline Channel Kit 810*70*20	70	810	23	480	330
CHA0742	CHA0827	Newline Channel Kit 910*70*20	70	910	23	530	380
CHA0674	CHA0759	Newline Channel Kit 1110*70*20	70	1110	23	630	480
CHA0681	CHA0766	Newline Channel Kit 1310*70*20	70	1310	23	730	580
CHA0698	CHA0773	Newline Channel Kit 1510*70*20	70	1510	23	830	680
CHA0704	CHA0780	Newline Channel Kit 1710*70*20	70	1710	23	930	780
CHA0711	CHA0797	Newline Channel Kit 1910*70*20	70	1910	23	1030	880

DESCRIPTION:

The Newline Channel Drain system was designed for use to complement the Newline ProFinish Tile Over Tray. Available with a high-quality Marine Grade stainless steel cover or tile insert, the Newline Channel Drain system has black or chrome finish options.

Newline Channel Drains are available in sizes from 710mm up to 1910mm, to suit a range of different sized trays.

CONTRIBUTIONS TO COMPLIANCE

B2.3.1(c) (i)(ii) & B2.2.2 (b): Newline Channel Drains have a warranted durability of 10 years when maintenance standards are adhered to. Channel Drains are installed as components of a building system and can be replaced with removing building elements that have greater durability. Refer to installation guide, warranty document and aftercare document for further information.

G13: The Newline Channel Drain is designed to convey foul water from sanitary fixtures, e.g. shower trays, to a properly plumbed drainage system. The system can be easily cleaned by flushing through the drain system only, providing reasonable access to maintain and clear blockages.

SCOPE OF USE

Newline Channel Drains are intended for use in the following environments:

- Domestic and commercial bathrooms with ProFinish tile over trays. The system has been aligned to Newline designs. If used outside steps outlined in the installation instructions, ensure this complies with council regulations.
- Suitable for use with cold and warm water.
- Not suitable to be used where permanently concealed.

WARNINGS AND BANS

This product is not subject to warning or bans under section 26 of the Building Act 2004.

CONTACT DETAILS

Location: NZ for Local and Imported Products

Legal and Trading Name of Manufacturer:
Newline Group Ltd

Importer Address for Service:
54 Unutoto Place, Tauranga, 3171

Importer Website: newline.nz

Importer Email: info@newline.co.nz

Importer Phone Number: 0508 NEWLINE

CONDITIONS OF USE

- Newline Channel Drains are intended for use under regulated water pressure and temperature that does not exceed 55 degrees Celsius, have heavy mineral loadings, geothermal qualities, or pH imbalance.
- Black powder coating is not included in the Channel Drain warranty according to B.2.2 (B). Black elements hold a 2-year warranty.
- Must be installed in accordance with Newline Channel Drain instruction manual, Newline recommends using a licensed plumber or tradesperson to conduct the installation to ensure best outcome.
- Cleaning products including bleaches, solvents, alcohol, citrus based chemicals, bath oils, and/or any abrasive cleaner should not be used. Full list is outlined in Aftercare Document.

SUPPORTING DOCUMENTATION

The following additional documentation supports the above statements:

[Aftercare and Maintenance Doc](#)

[Warranty Information](#)

[Channel Drain Instruction Manual](#)