

Installation Instructions for Kāinga Ora Builds



Important

1. When you receive your shower package, please check for any freight damage.
2. If damage has occurred, advise your supplier within 8 hours.
3. Do not install any faulty product as this will invalidate later claims.

WAIT

1. Newline provides “Acrylic Pre-install” Specifications for Build preparation, plumbing, tray & liner alignments to ensure all steps have been adhered to prior to this current installation.
2. Shower tray and acrylic liner must be completed prior to this installation.
3. Read these current instructions through, familiarise yourself with all aspects of installation, tools required, and materials used.

HEALTH AND SAFETY

- Unpack glass, stand on soft packing on floor and walls prior to assembly.
- Do not rework glass panels as toughened glass will explode without warning.
- Don't strike an edge or corner of glass as this may explode or be unusable.
- Use two persons where heavy glass lifting is required.
- Wear appropriate protective clothing and eye protection during installation.
- Mark gas/water pipe and electrical wire locations to ensure these are not touched.

WARRANTY

- This covers faulty goods but not breakages. View newline.nz
- Compliance with Acrylic Pre-install Specifications and these instructions are essential for a valid warranty.

ATTENTION

- Walls must be flat and plumb to ensure adjustments can be obtained.
- Note Re 3-Sided Showers: Walls must not bow or lean inwards as errors will duplicate restricting the shower assembly fit.

It is the installers responsibility that the installation complies with all council regulations.

Provide studs for wall channels centred at 35mm inwards of tray edge.

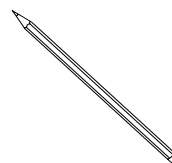
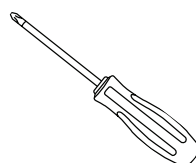
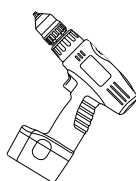
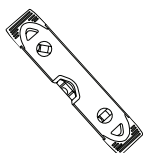
TOOLS AND MATERIALS REQUIRED

TYPE: #1 Square

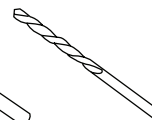
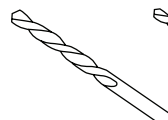
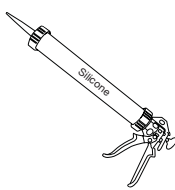

3.0mm 2.0mm
NUMBER & TYPE



PROCESS

2-Sided

Before commencing installation, please ensure you have the following components in your package to complete installation.

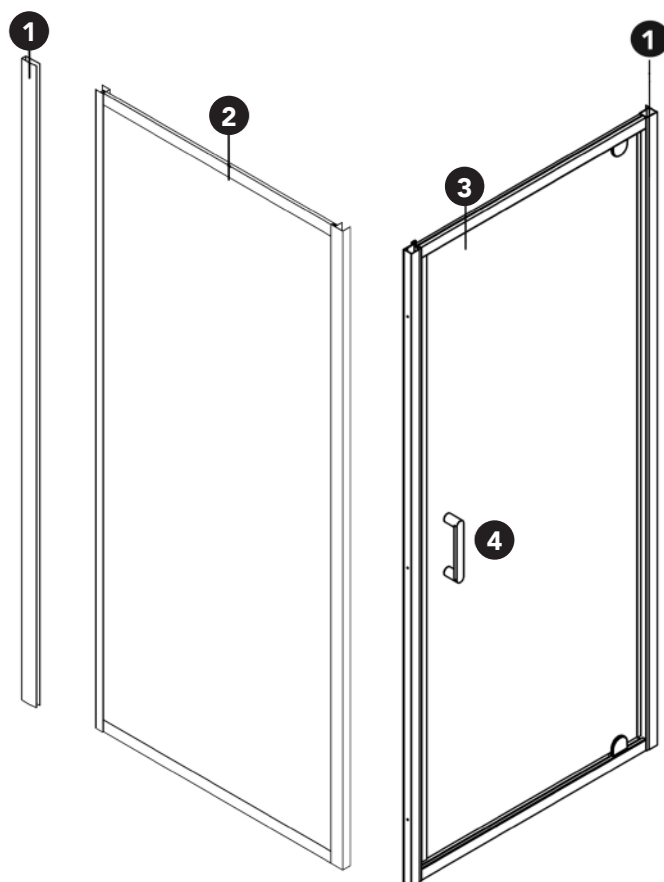

REF	TICK	DESCRIPTION	PART NO.	QTY
1		Wall Channels		2
2		Fixed Return Panel		1
3		Door Front Assembly		1
4		Handle Set		1
5		Fixed Panel Screws 4 x 10mm		9
6		Fixed Panel Screw Caps		15
7		Wall Jamb Fixing Screws 3.5 x 35mm		6
8		Wall Plug (Concrete)		6
9		Bottom Door Seal		1

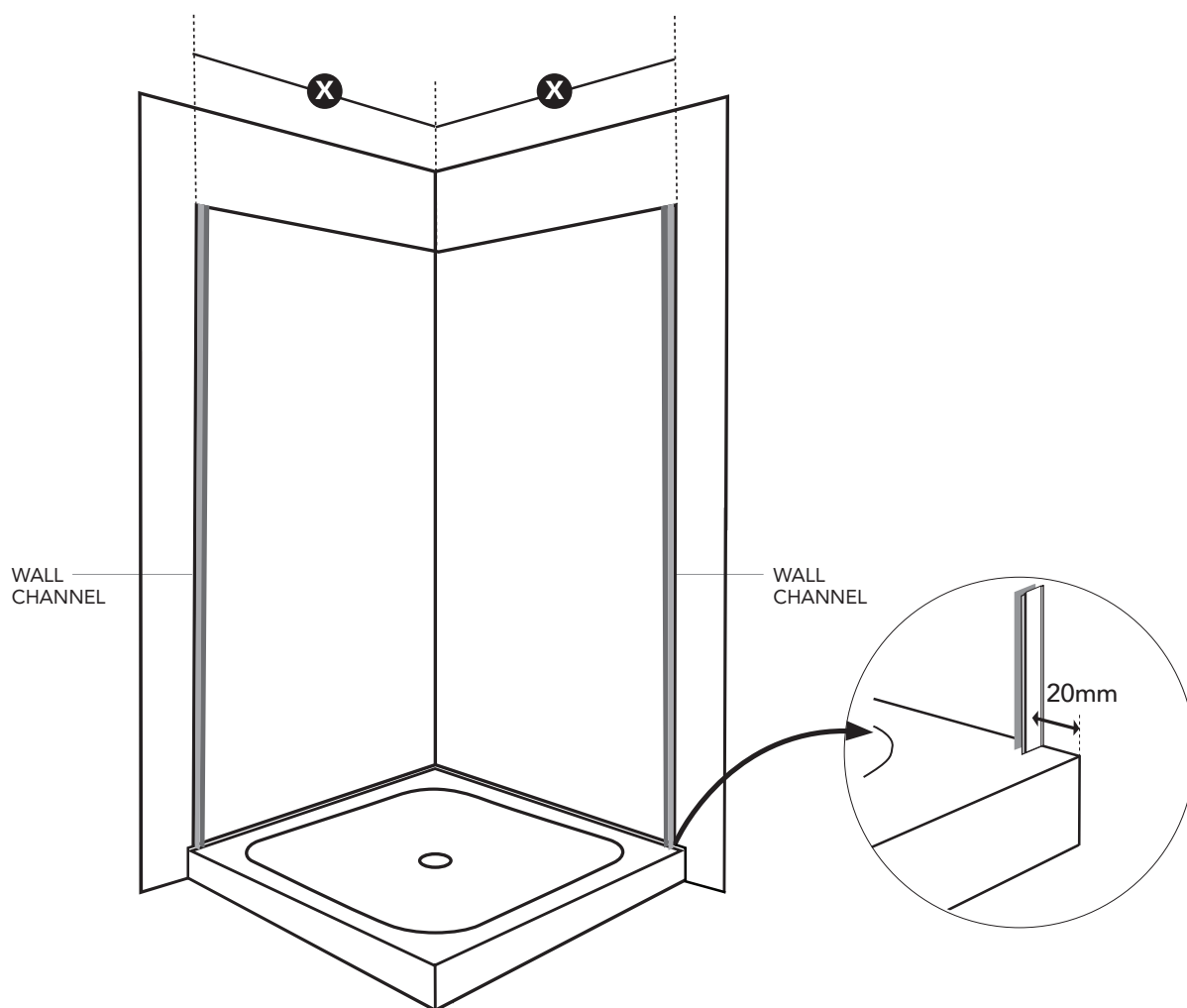
**IMPORTANT:**

1. Position the wall profiles at 20mm off the acrylic tray edge.
2. If the tray is not level, walls not flat or out of plumb, assess if the given layout will work or adjust positioning as required.

INSTALLATION STEPS: PAGE 5 TO 8**MINIMUM AND MAXIMUM TABLE**

Wall out of plumb will not allow the full minimum / maximum range.

SHOWER TYPE	DOOR SET MIN/MAX	RETURN PANEL MIN/MAX
820 x 820	776 - 793	786 - 803
915 x 915	863 - 880	880 - 897
1000 x 1000	966 - 983	967 - 984

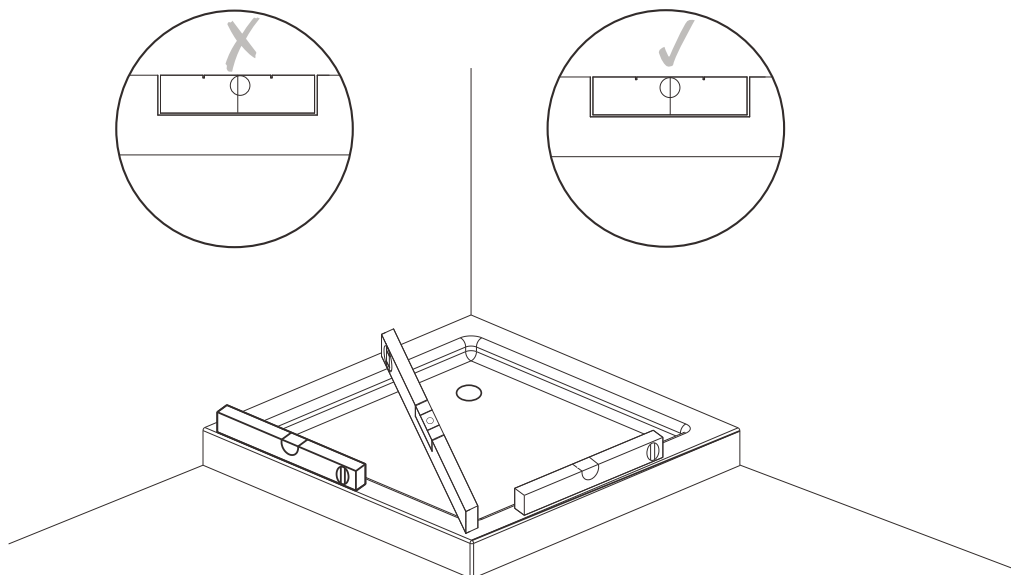
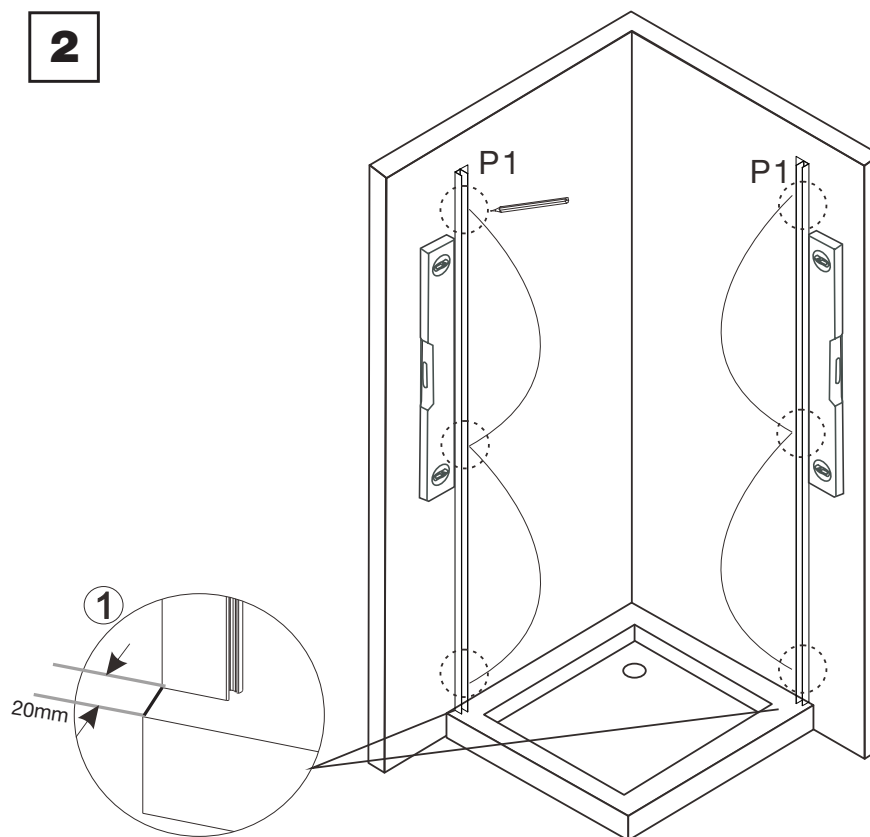
1**2**

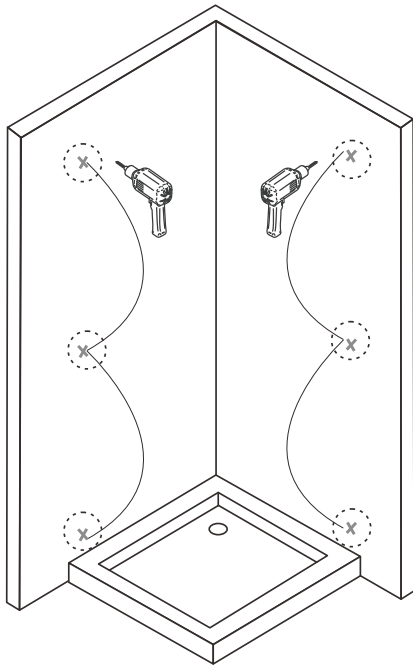
3

From marks,
predrill a 2mm
hole in liner.

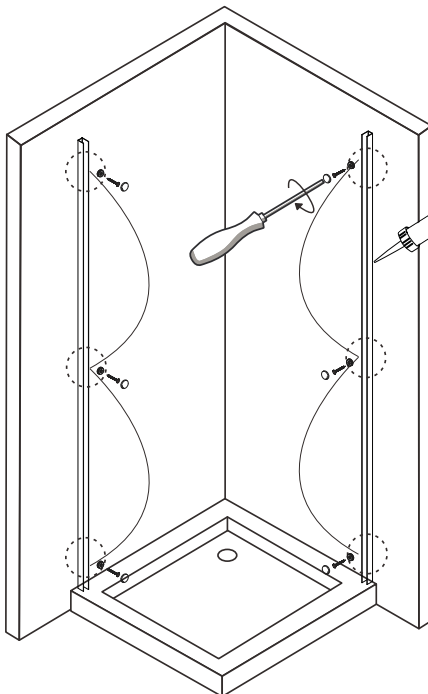
4

Apply continuous
bead of silicone
to the rear
face of the wall
channel before
placing against
the liner

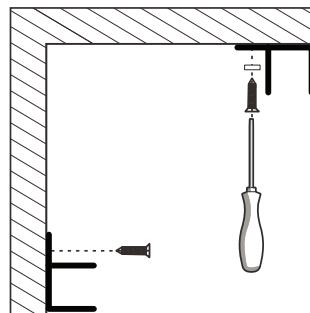

Fit Screw Caps.

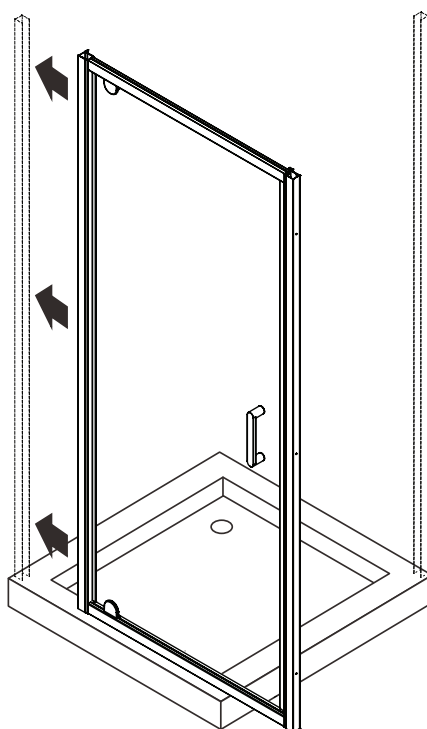
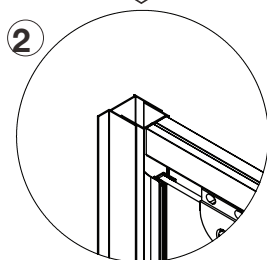
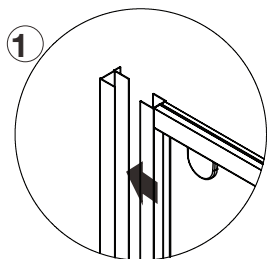
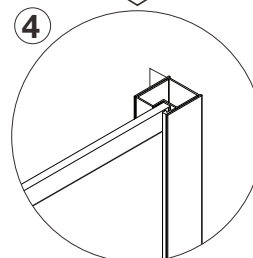
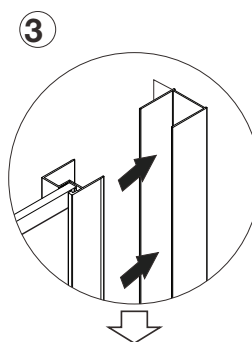
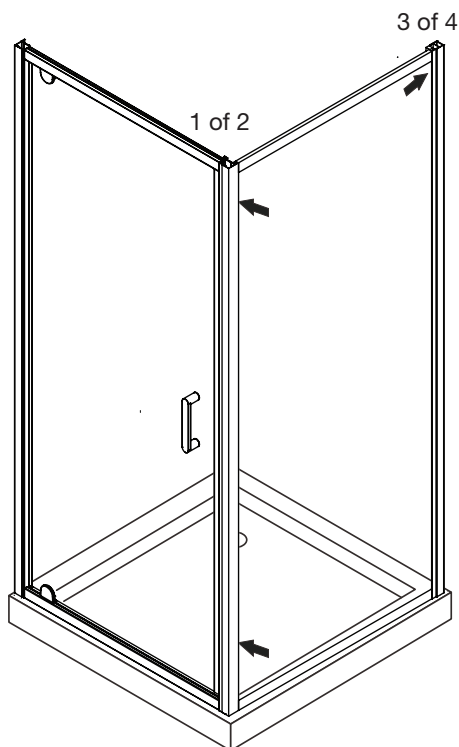
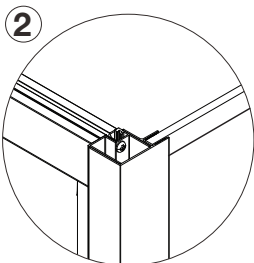
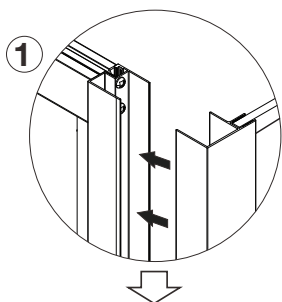
5**6**

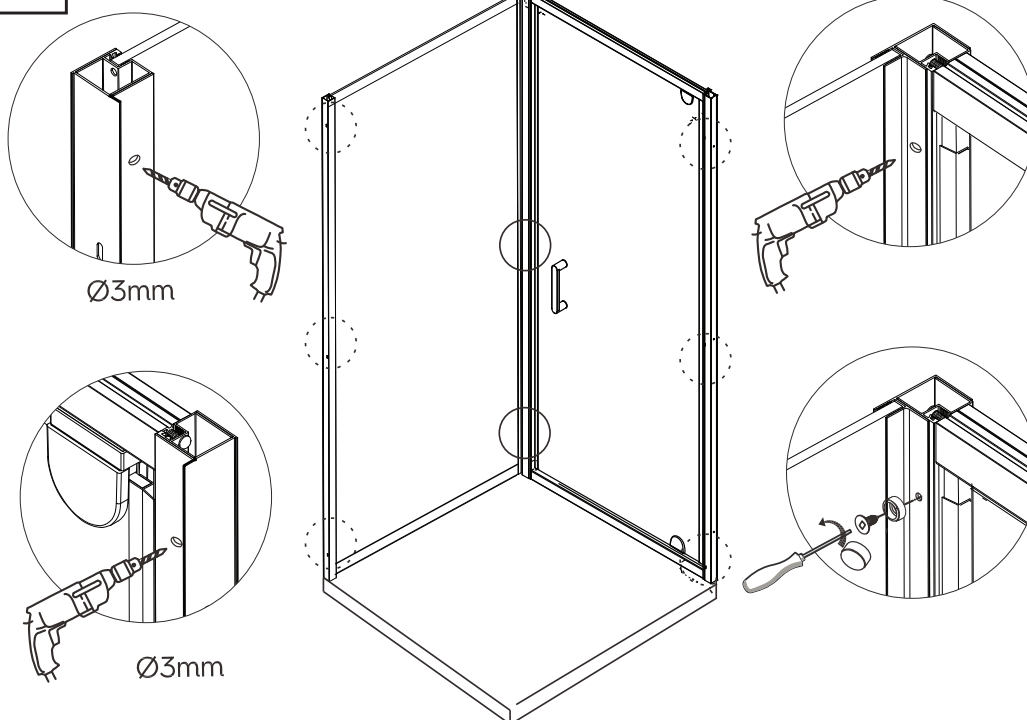
7**8**

Seal the join
between wall
channel and frame.
150mm up from
base on both sides

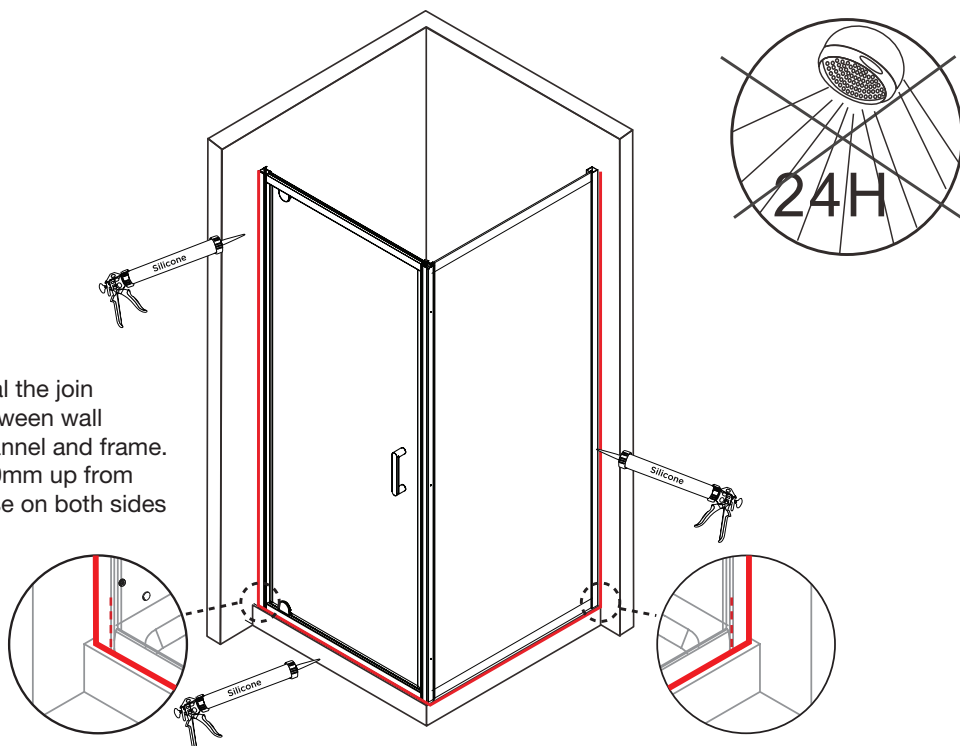

Before commencing installation, please ensure you have the following components in your package to complete installation.

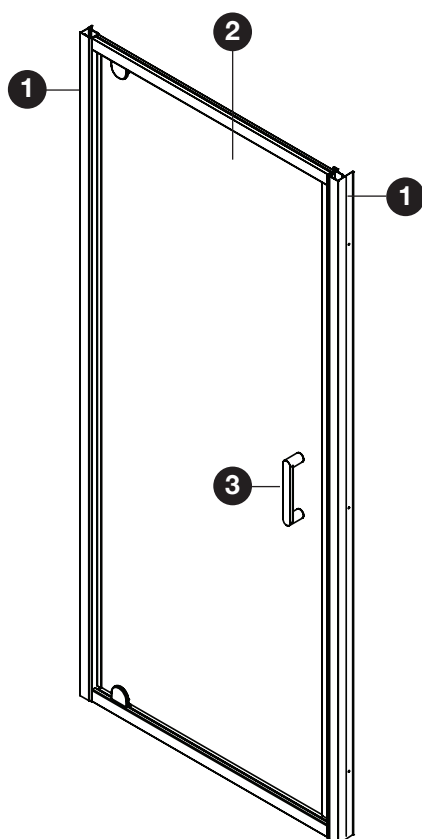

REF	TICK	DESCRIPTION	PART NO.	QTY
1		Wall Channels		2
2		Door Front Assembly		1
3		Handle Set		1
4		Screws 4 x 10mm		9
5		Screw Caps		15
6		Wall Jamb Fixing Screws 3.5 x 35mm		6
7		Bottom Door Seal		1
8		Wall Plugs (Concrete)		6

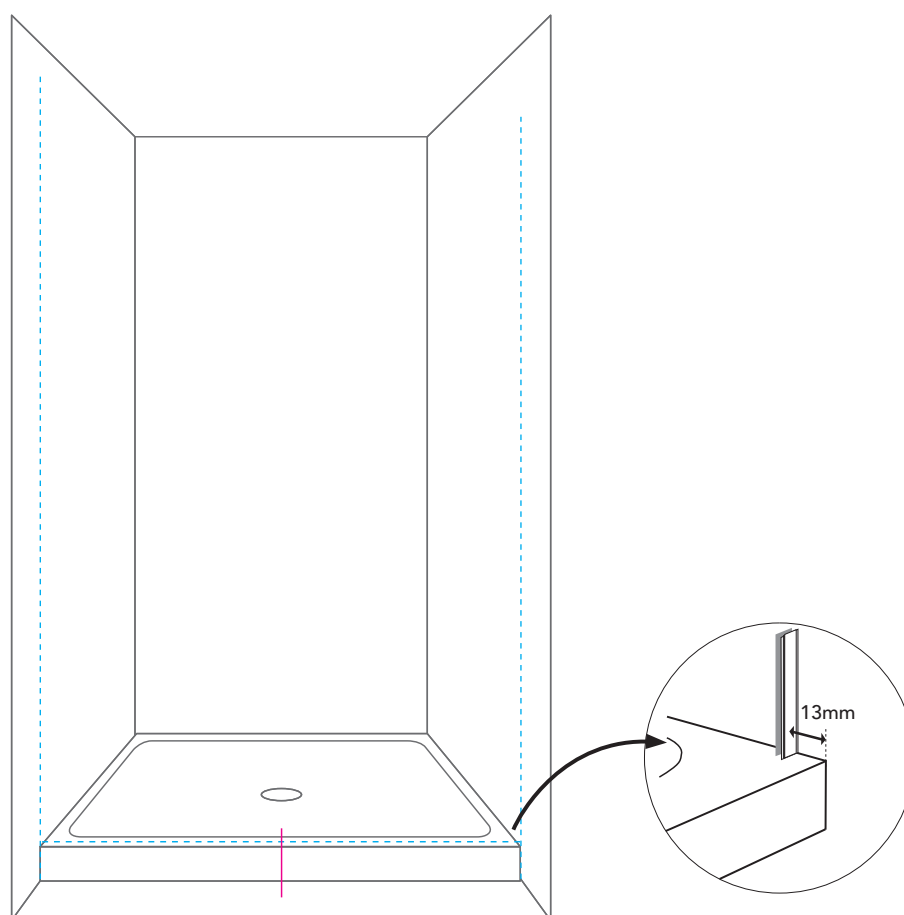
**IMPORTANT:**

1. Position the wall profiles at 13mm off the acrylic tray edge.
2. The walls must be plumb with no curve or leaning inwards as errors duplicate.
3. Table 1 below: This outlines the small clearance for the Door Set to lined walls.

INSTALLATION STEPS: PAGE 10 TO 13**MINIMUM AND MAXIMUM TABLE**

Wall out of plumb will not allow the full minimum / maximum range.

SHOWER TYPE	DOOR SET MIN/MAX
810 (3-Sided)	780 - 811
900 (3-Sided)	867 - 898
1000 (3-Sided)	970 -1001

TABLE 1: 3-SIDED TRAY LAYOUT (LOW PROFILE ACRYLIC TRAYS)

TRAY SIZE	FRAME TO FRAME	WALLBOARD TO WALLBOARD	ACRYLIC LINER TO LINER
810 x 810	810	790	785
900 x 900	900	880	875
1000 x 1000	1000	980	975

Framed walls must follow Table 1.

Rebate bottom plate if tray too tight.

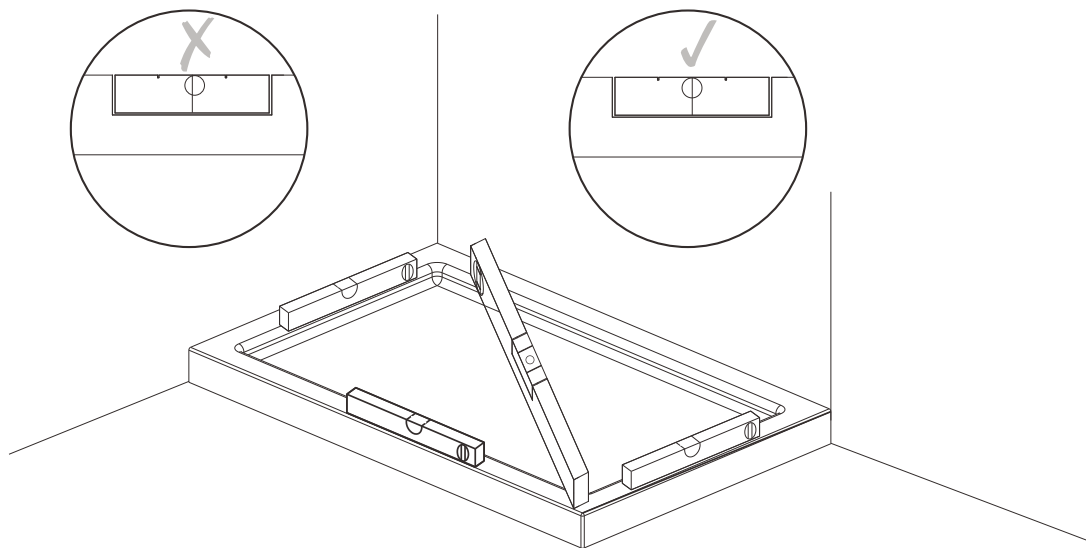
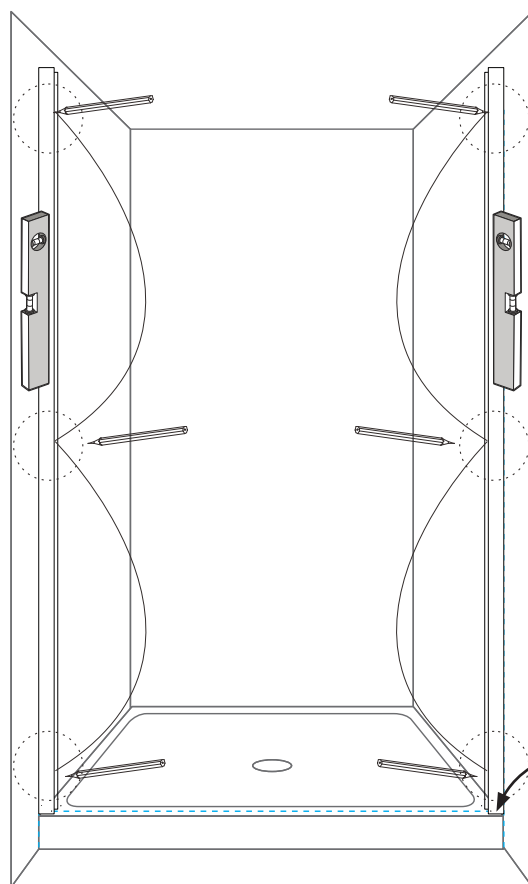
1**2**

Mark wall
channel holes
and pre-drill 2mm
holes in Acrylic
Liner

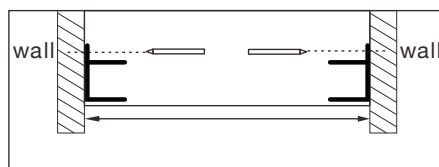
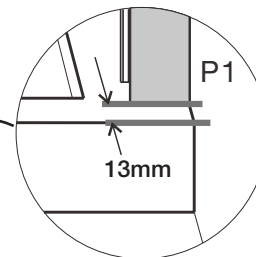

3

With assistance, enter the Door Set with Wall Channels each side to pre-drilled holes.

Start some screws in holes to hold. Feed silicone into each hole and screw off using the screw caps.

Apply continuous bead of silicone to the rear face of the wall channel before placing against the liner

Enter Doorset with wall channels each side.

4

Square up Frame to Wall Channels and Door to Frame.

1

2

1

2

5

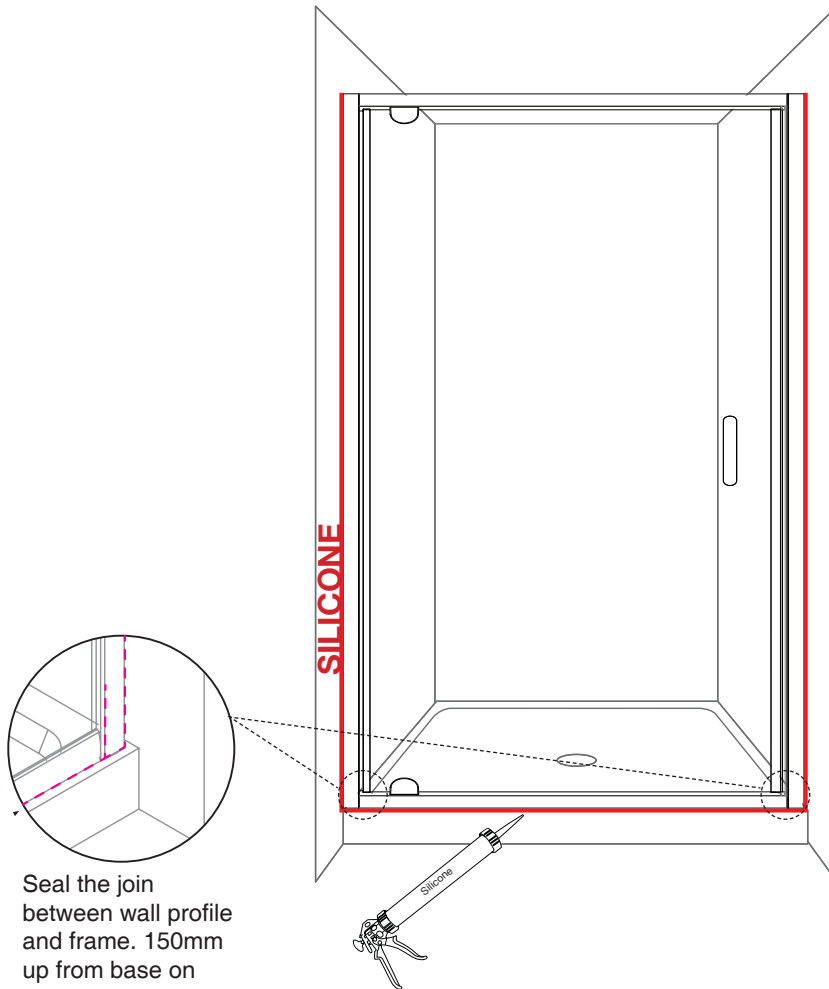

NEWLINE
for a lifetime!

54 Unutoto Place, Tauriko, Tauranga, 3171

Freephone: 0508 639 5463 Phone: 09 444 2053

Email: info@newline.co.nz

newline.nz