



## About

---



Newline is a New Zealand owned and operated company based in Tauranga. We have been manufacturing and distributing showers for over 40 years and during this time have introduced a number of innovative products to the New Zealand market.

**NEWLINE**  
*for a lifetime!*

---

# Contents

---

- 1 Introduction
- 3 Tile Tray Options - Hobbed
- 5 Tile Tray Options - Recessed
- 7 Recessed Tray Details
- 8 Wedge Tile Tray
- 9 Tile Tray Centre Waste - Installation Guide
- 11 Tile Tray & Channel Drain Kit - Installation Guide
- 13 Jigsaw Tile Tray System
- 17 Barrier Free Floor System
- 19 Recessed Tile Shelf
- 20 Tile Wastes Channel Drain
- 21 Tile Wastes Centre Waste
- 22 Waterproofing
- 23 Custom Order Form

# Tile Tray System Introduction

---

**The ProFinish™ Tile Tray System is made in New Zealand from high density, environmentally safe, rigid polyurethane, and replaces the need for a traditional sand and cement sloped tile shower base.**

The ProFinish™ Tile Tray System offers unrivaled flexibility, as trays can be custom manufactured to suit individual requirements. ProFinish™ Trays are easy to install, can accommodate either a channel drain or standard tile waste, are suitable for above floor or recessed application, and can be manufactured to accommodate virtually any waste position.

Once your wall lining has been installed the tray is glued to the floor and one continuous waterproofing membrane is covered over the floor, tray and up the walls. Then the whole enclosure is ready for your tiles to be applied.

---

## FEATURES AND BENEFITS

- Designed and made in New Zealand from high density rigid polyurethane.
- Simply adheres to the floor.
- Guaranteed to hold its shape and form for 20 years if protected from moisture by an approved waterproofing applicator (refer page 22).
- Installed after the wall lining is fixed and must be waterproofed before tiling.
- The waterproofing is to be applied after the tray is installed so the area is protected by one continuous waterproofing membrane applied to the floor, over the shower base and up the walls.
- Provides an accurate gradient fully compliant with the NZ Building code.
- Simplifies the resource consent process.
- Can be installed on solid timber, particle board or concrete floors, or a slate/tile underlay. ProFinish™ Tile Tray must be installed on a clean, flat, level surface.
- Offers flexibility with the size, shape and waste position and so removes the need for expensive structural floor changes.
- Compatible with channel drain or standard tile waste. Tile waste not included with tray unless requested. Channel drain system includes the channel drain kit.
- Trays standard with 60mm x 60mm hob. Custom and recessed options available.
- The Profinish tray can be waterproofed the following day after installation, eliminating the drying time traditional screed has, potentially speeding up your project
- All dimensions from lined wall to outer edge of ProFinish™ Tile Tray are nominal.

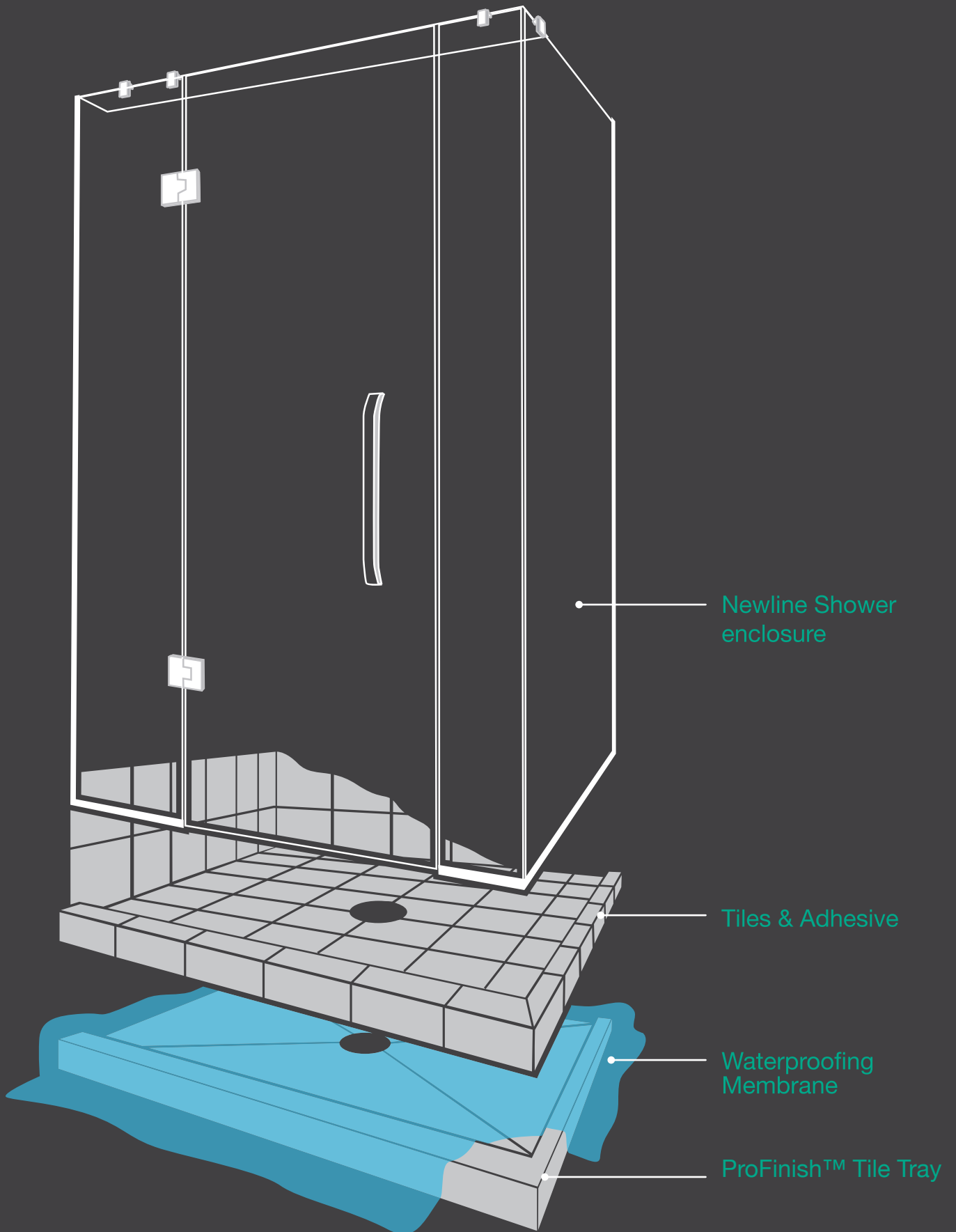

# Tile Tray Options - Hobbed

## Hob Centre Waste

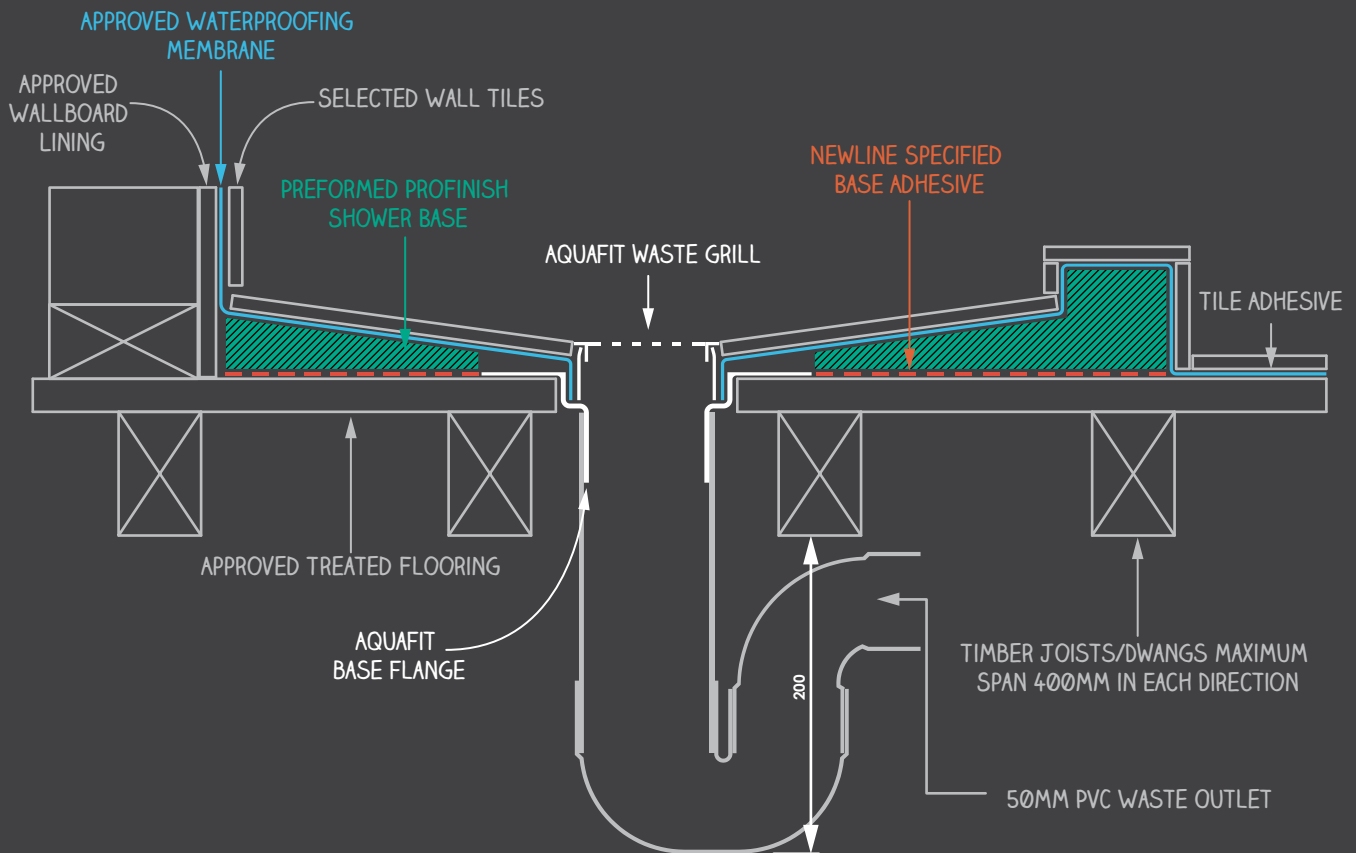

## Hobbed

The Profinish hobbed version comes standard with a 60x60mm hob/sill on the front edges of the tray. Profinish hob/sill come standard with a 1 degree fall on the top surface to ensure no water pools in that area. Newline can customize the size of the hob/sill to any size you desire. The Profinish hobbed trays are designed to be adhered to the surface of the substrate such as the concrete floor or timber floor.

Profinish hobbed tray comes in centre waste or channel drain waste which runs opposite where the shower door will be located as standard. Newline does have the ability to customize to any waste or channel drain position that you require. Where a standard point drain waste position is required to be customized it cannot be any closer than 200mm from the wall to enable the leak proof control flange to fit.

## Hob Channel Drain

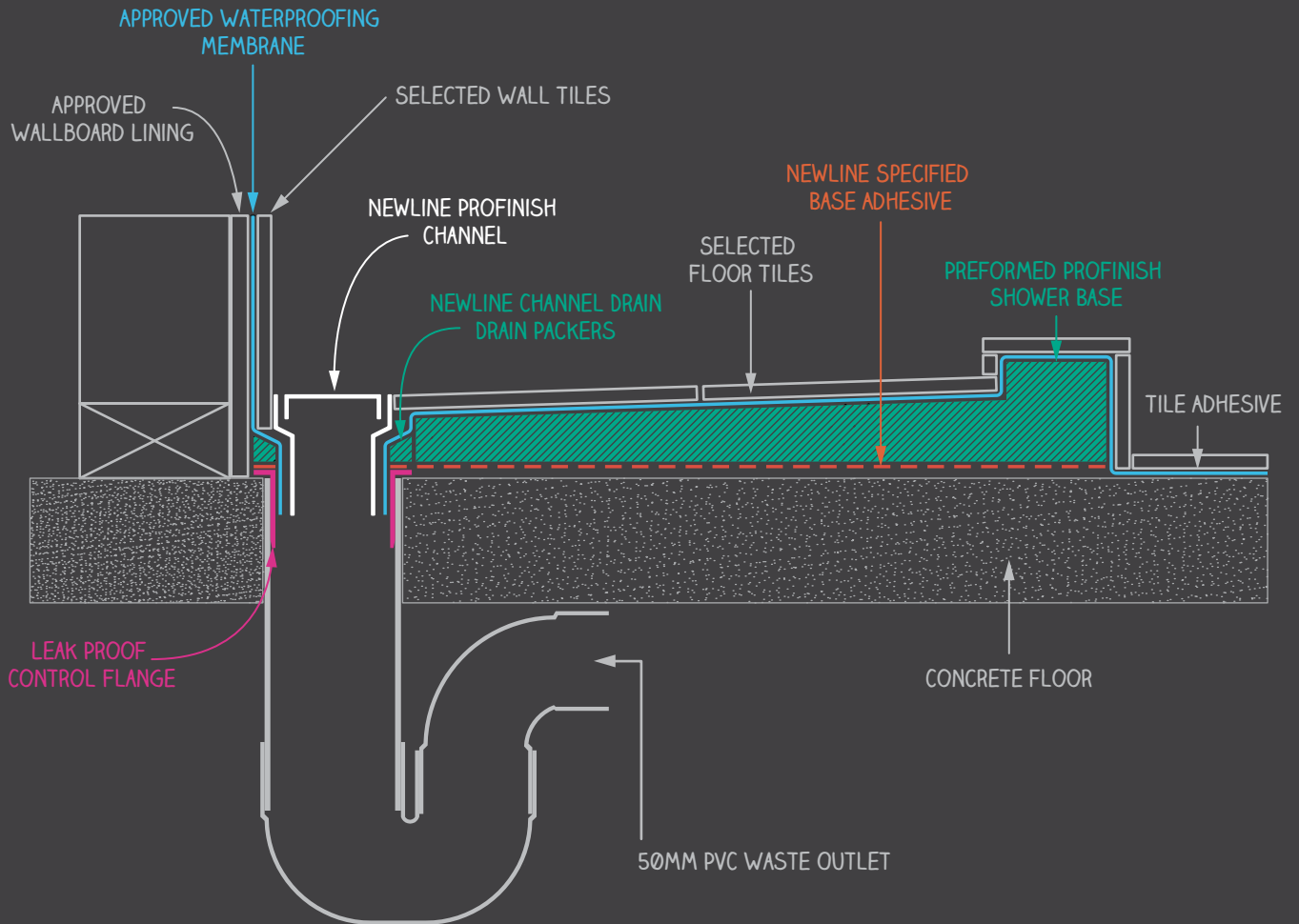

Drawings are conceptual and not proportional due to page limitations.

# Tile Tray Options - Recessed

## Recessed Centre Waste

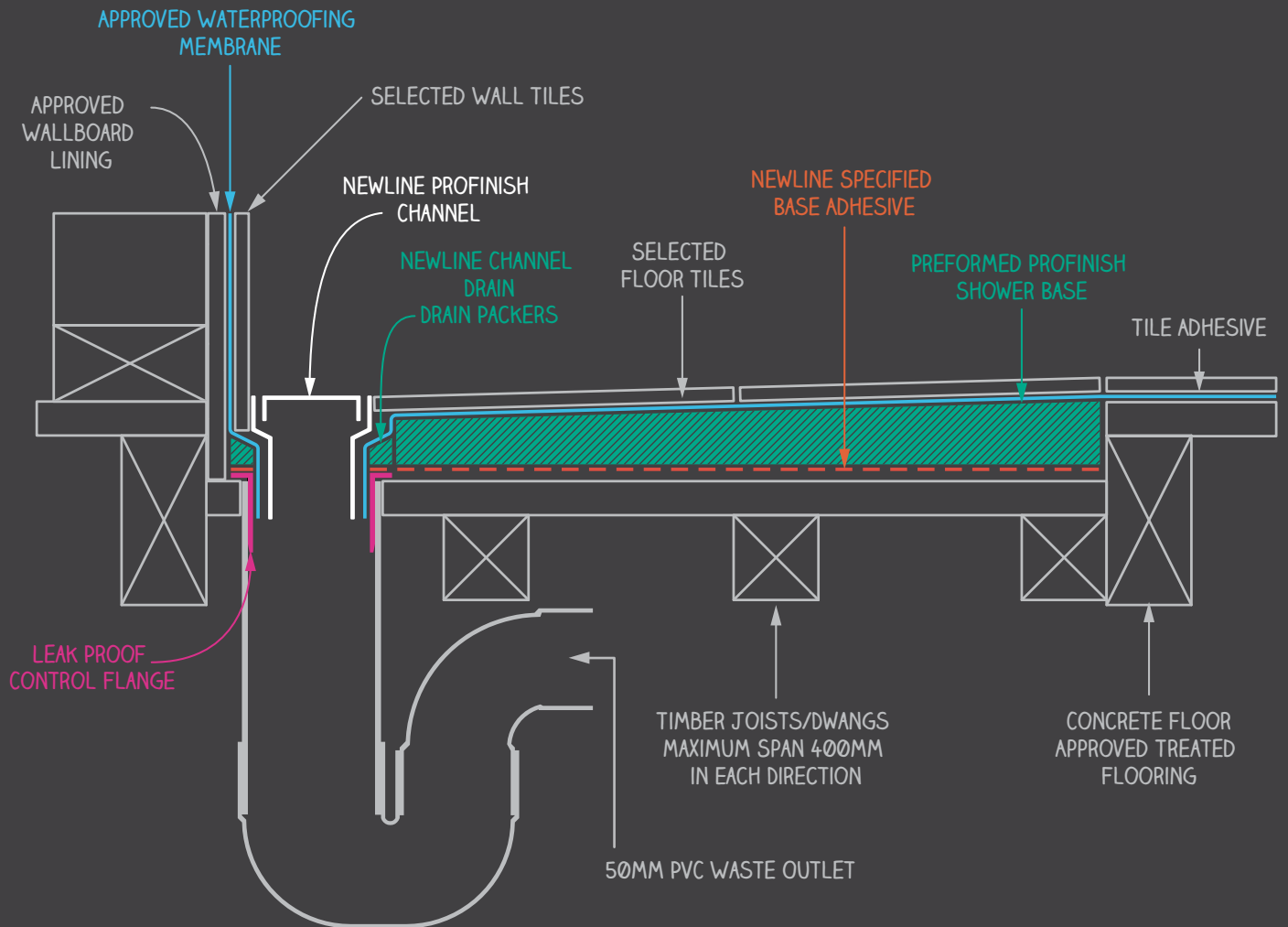

## Recessed

The Profinish recessed version does not have hob/sill on the front edges of the tray, this is to generate a level entry shower floor. The substrate needs to be cut out in order to create a recess for the Profinish tile tray to sit down into also allowing for the waterproofing and the tiles to be installed.

Profinish recessed tray comes in centre waste or channel drain waste which runs opposite where the shower door will be located as standard. Newline does have the ability to customize to any waste or channel drain position that you require. Where a standard point drain waste position is required to be customized it cannot be any closer than 200mm from the wall to enable the leak proof control flange to fit.



## Recessed Channel Drain

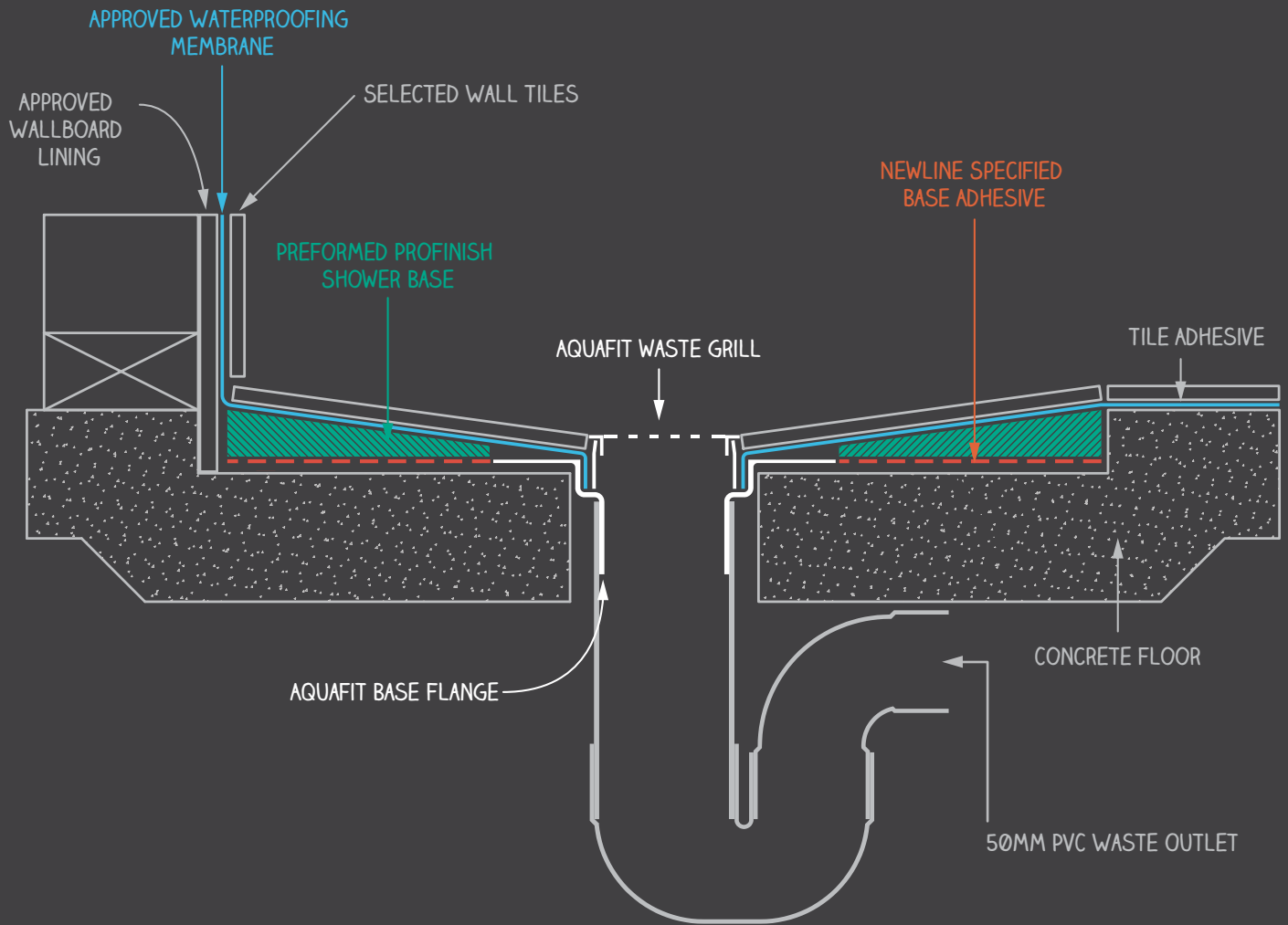

Drawings are conceptual and not proportional due to page limitations.

# Recessed Tray Details

## Tile Waste Recessed

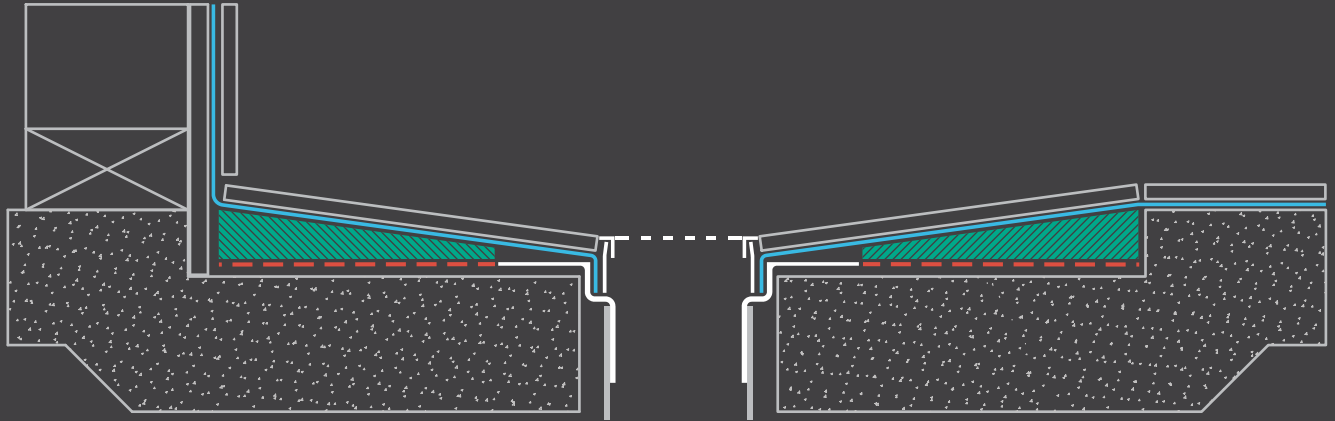

## Channel Drain Recessed

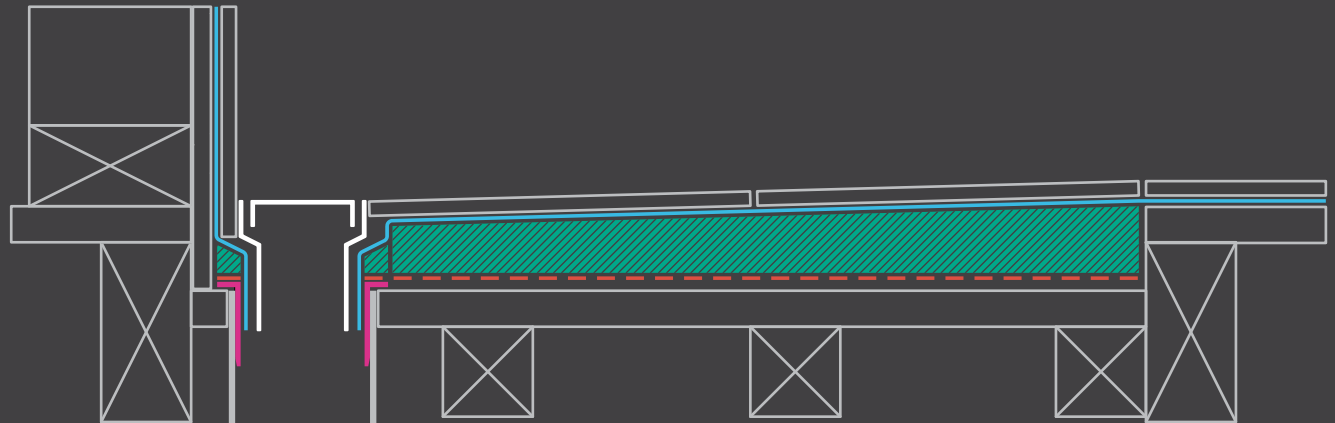

### Recessed depths - Tile Waste

MM FROM CENTRE OF WASTE	TRAY THICKNESS FROM OUTSIDE EDGE / MIN RECESS DEPTH
500mm	21mm
600mm	24mm
700mm	27mm
800mm	30mm
900mm	33mm
1000mm	36mm
1100mm	37mm
1200mm	38mm

### Recessed depths - Channel Drain

MM FROM CHANNEL EDGE OF PROFINISH™ WEDGE TRAY	FLOOR CUT OUT DEPTH (Tolerance of + or - 2mm)
800mm	38mm
1000mm	41mm
1200mm	45mm
1400mm	48mm
1600mm	51mm
1800mm	55mm

# Wedge Tile Tray – Guidelines for Recessed Application

## Example

1200 x 1000 Shower

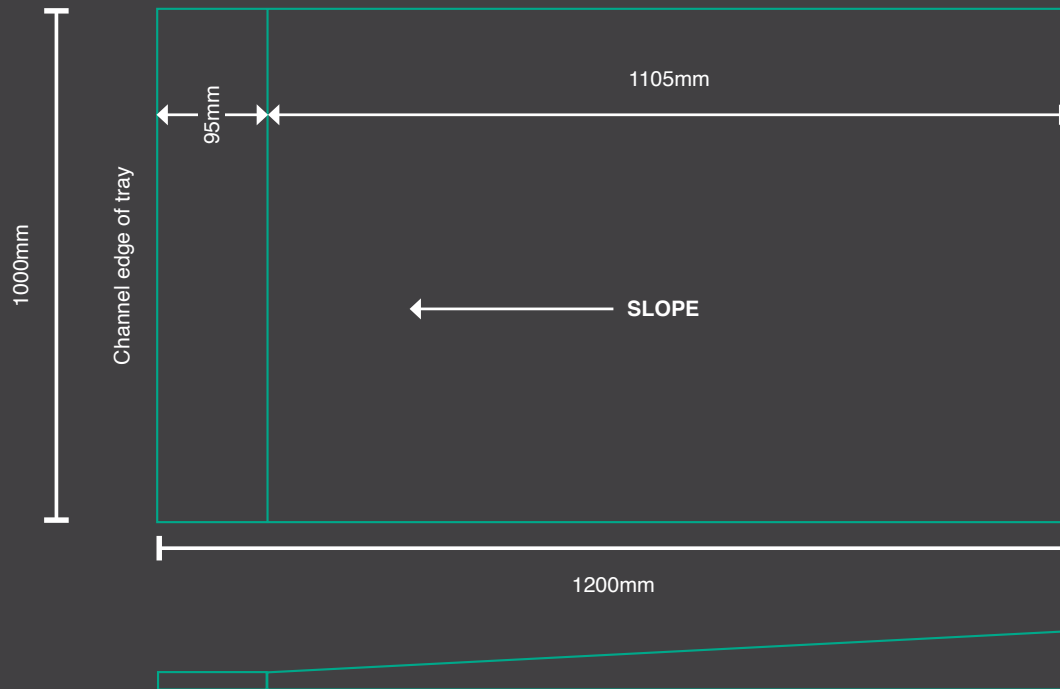

## Please note:

1. The depth measurement provided for channel drain tray starts at 26mm, which is the minimum thickness of the ProFinish™ Wedge Tile Tray when installed with a Newline Channel Drain Kit and the ProFinish Packer.
2. The tray measurements are taken from the outside edge of the tray and include the channel drain.
3. No allowance has been made for the thickness of the waterproofing or the tiles.
4. Please allow for a variance of + or – 5mm when using the chart on page 7
5. Please make allowance for the adhesive and waterproof membrane.
6. When measuring recess depth for tile waste always measure from the furthestmost point. eg 1000x1000 tray with waste position 300mm from the wall. the measurement will be taken from the furthestmost side which is 700mm

# Tile Tray Centre Waste – Installation Guide



Before you begin, ensure floor area is clean, free of dust and surface is flat and level. Check using a spirit level and, if necessary, use a suitable leveling compound to correct any unevenness. When fitting tray to a timber floor we recommend the use of a tile and slate underlay, especially if the wooden floor has been oiled.

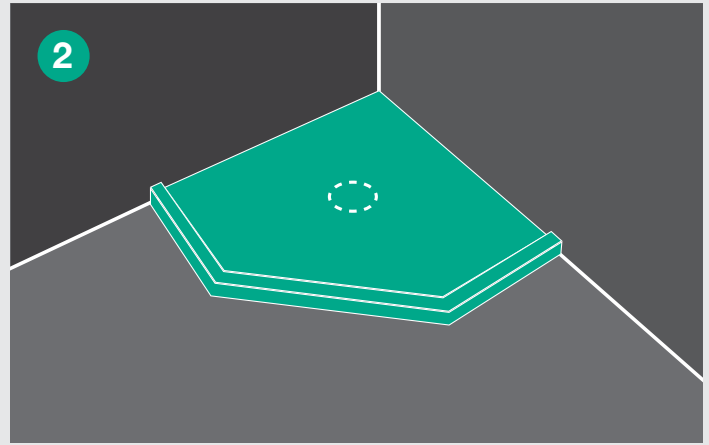

There is a marked centre for the waste on the ProFinish tray, drill a small hole through the tray on the mark. Position tray, mark waste through centre hole and mark outer boundary of tray.

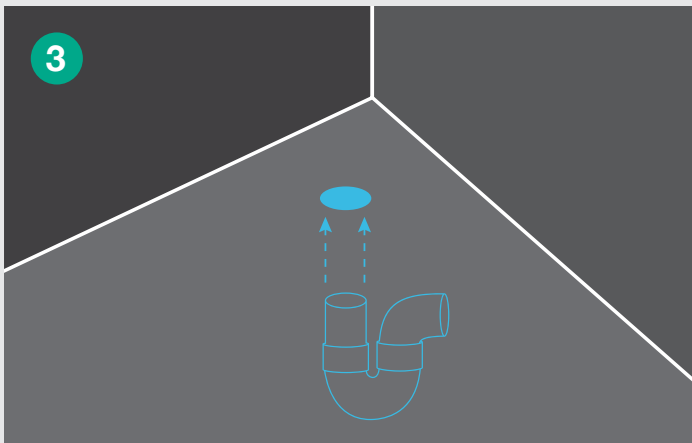

Remove the tray, drill hole for tile waste and install in position. (Options: Easy Clean Tile Waste or "P" Trap Tile Waste). This must be carried out by a registered plumber.

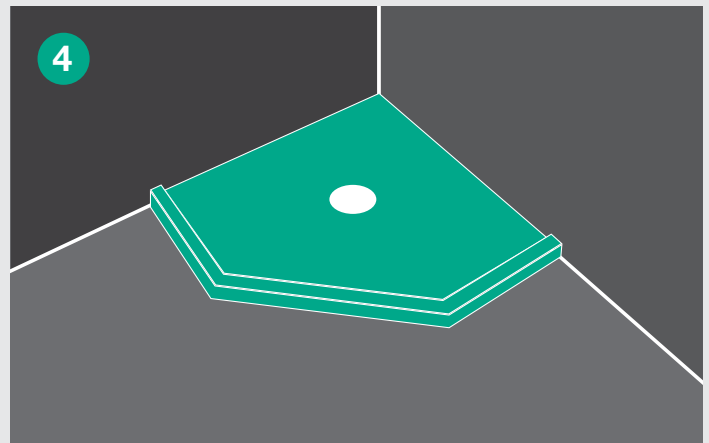

Use a sharp knife to cut around the outside of the waste flange until the tray fits neatly around the waste flange outer perimeter.

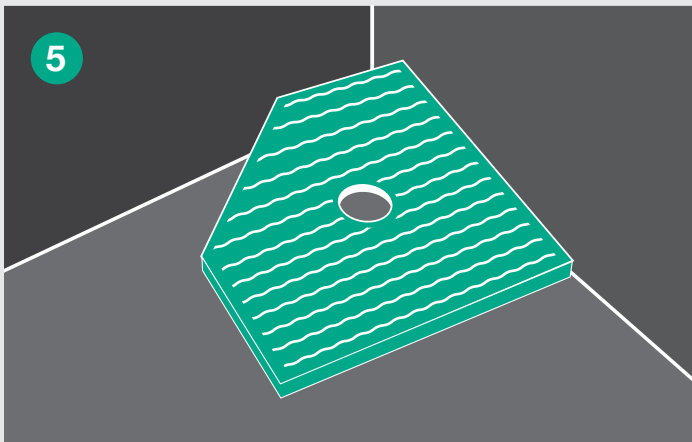

Lift the base and apply the adhesive supplied to the bottom side of the base, using a 55mm beads commencing 20mm in from the outer edges.

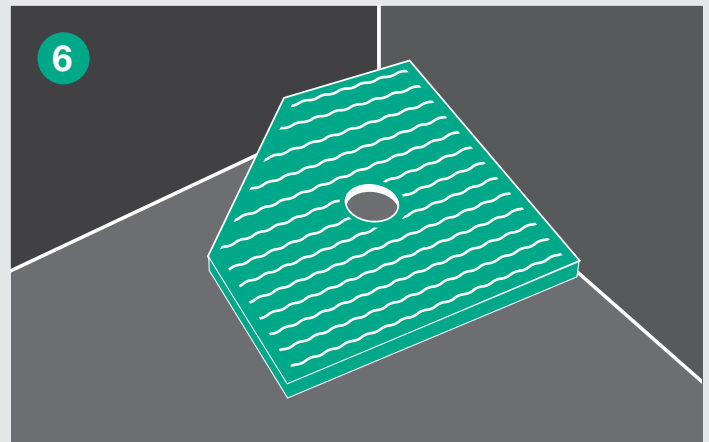

Ensure adhesive is applied to the hob ends - providing hob to wall joint adhesion.

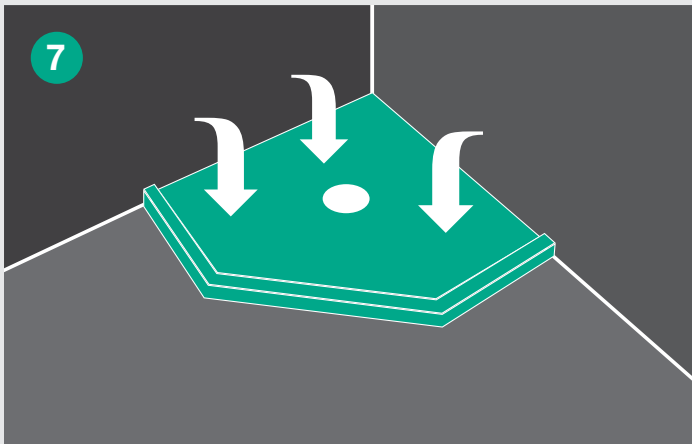

Place the tray on floor and apply pressure evenly to spread the adhesive. Lift up for 5 minutes to release solvents and reposition. Weigh down and hold tray in position. The room temperature must be above 10 degrees for the adhesive to cure. Allow 48 hours for adhesive to cure sufficiently to hold.

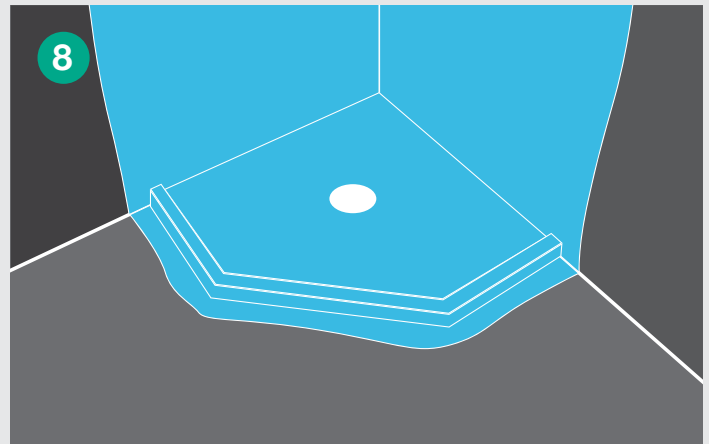

Once the tray is glued in place apply the waterproof membrane according to the manufacturer's instructions. Refer to the list of approved waterproofing manufacturers and products (page 20) and ensure your waterproofer or tiler uses one of these products. instruction.

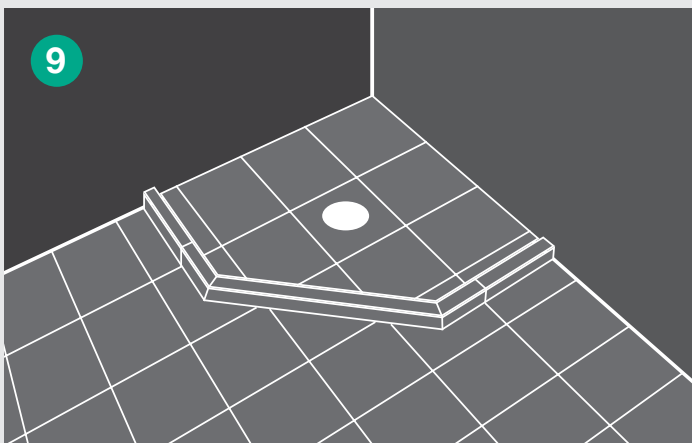

Ensure waterproofing is applied down into the waste flange and up the inside vertical face of the tile hob, across the top edge and down to the floor line on the outside of the ProFinish™ Tile Tray. Where frameless doors are to be fitted it is recommended that floor areas outside the shower should also have a waterproofing membrane applied, prior to tiling.

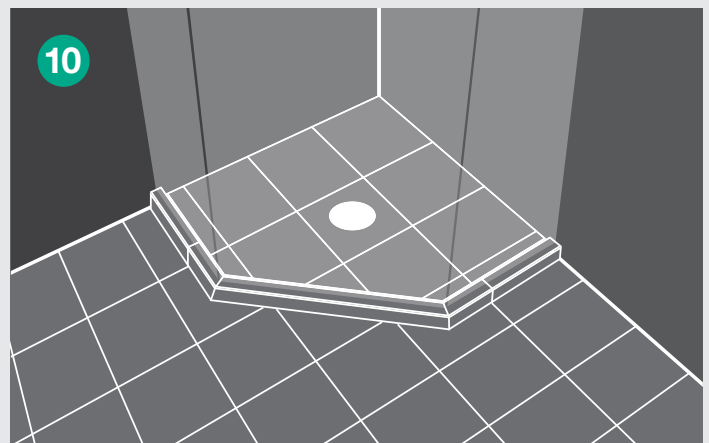

The ProFinish™ Tile Tray is now ready for tiling. Door and glass installation: In most cases Newline is able to provide a list of companies who can install your Newline glass door set.

### Tray Bonding Options:

**Option A Maxbond cartridge adhesive:** As outlined in the above diagrams

#### Option B Tile Adhesive Bonding

This option applies to Masonry surface, Tile and Slate underlay over Timber or Concrete surface.

1. Apply a C2S2 Tile Adhesive by troweling out the adhesive on the back of the tray and the floor area and applying the tray into the wet adhesive as a "wet on wet" contact.
2. Press the base down firmly in position ensuring 100% coverage and exclusion of air.
3. The waterproofing first coat can proceed immediately but there "must not" be any pressure placed on the ProFinish tray until the full cure time of the tile adhesive is reached.

Partially cured tile adhesive risk adhesion failure if weight is applied until fully cured.

**Approx curing times:** Standard C2S2 8 hrs minimum. Rapid C2S2 2hrs minimum.

**Consult with your supplier:** For their specific recommended cure times and conditions

# Tile Tray & Channel Drain Kit – Installation Guide

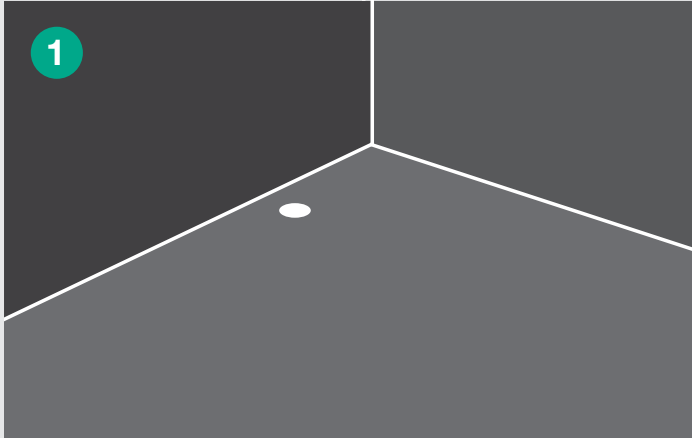

Before you begin, ensure floor area is clean, free of dust and surface is flat and level. Check using a spirit level and, if necessary, use a suitable leveling compound to correct any unevenness. When fitting tray to a timber floor we recommend the use of a tile and slate underlay, especially if the wooden floor has been oiled.

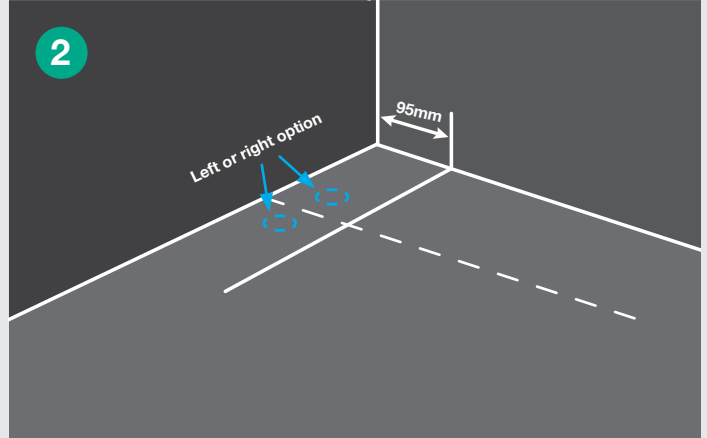

Mark the centreline of the tray (excluding hob). With the supplied channel drain template, match the centre of the tray with the template. Mark the optional LH or RH waste and 85mm outer line of template.

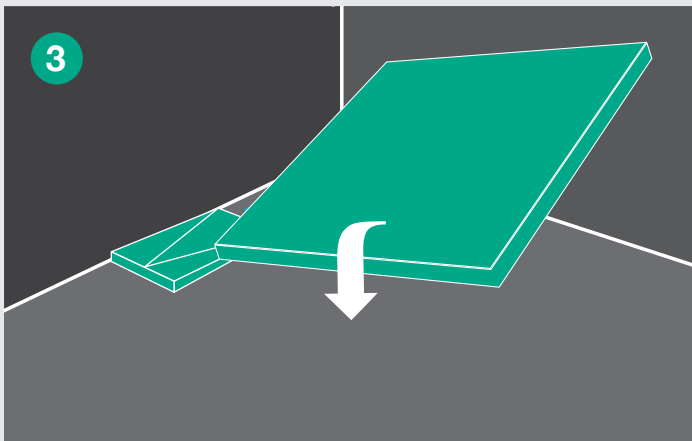

Trial fit all components: Wedge tray, Channel drain packers, leak proof waste flange (temporarily upside down). Check the packers fit neatly each side of waste flange. If needed trim packers at outside ends only.

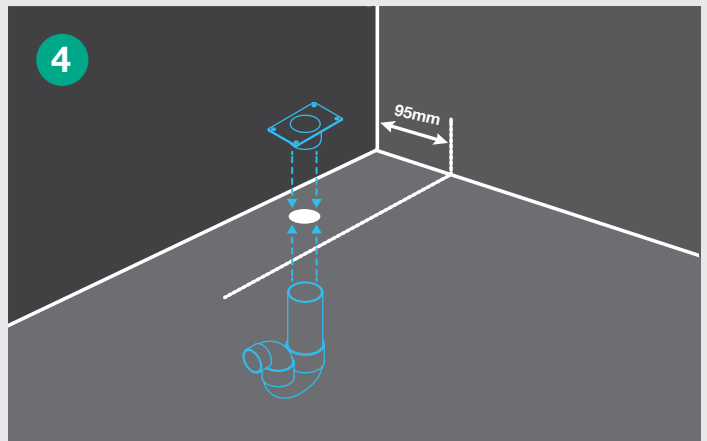

Install the waterproof flange to the flooring substrate within the marked area. Connect and seal the waterproof flange to the waste pipe. This must be done by a registered plumber.

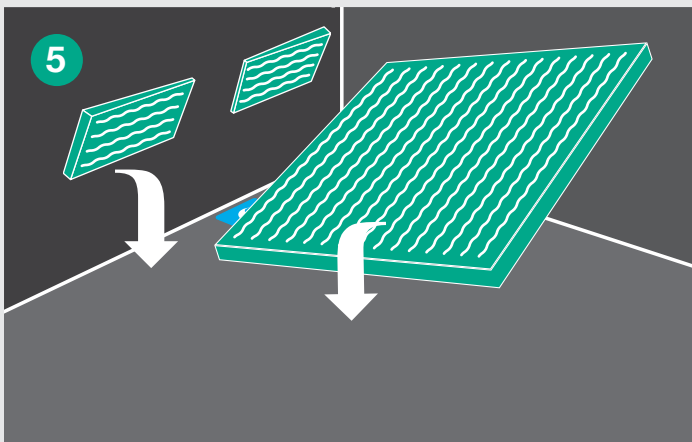

Apply the adhesive supplied to the ProFinish™ Wedge tile tray and packers with a 6mm bead every 55mm and 20mm from the outer edges. Tray must be fully supported by substrate.

**PLEASE NOTE:** Warranty is void if the recommended glue is not used.

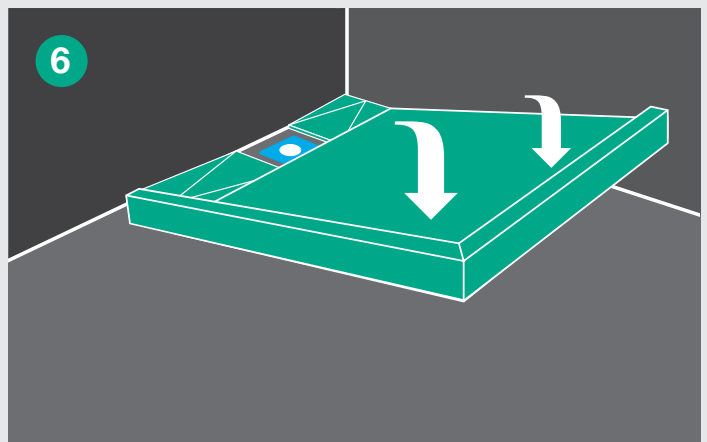

Fit back into place ensuring that the tray is firmly butting the Packer, and press firmly over the entire surface. To ensure adherence it is recommended that the tray be weighted to the floor until set (this setting time may differ depending on temperatures and environment).

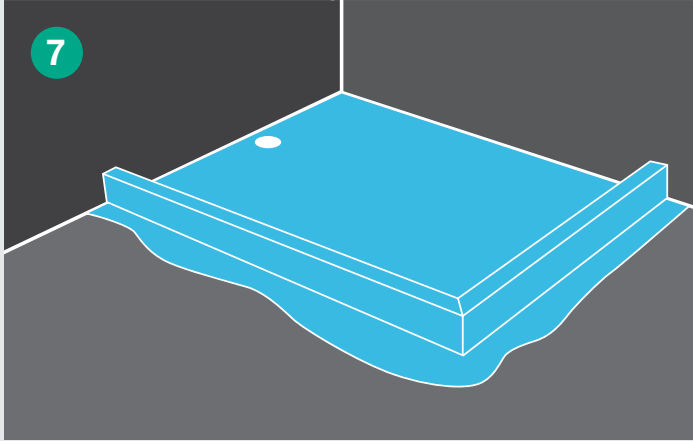

An accredited applicator can now apply the waterproofing membrane according to the manufacturer's instruction (refer to the list of approved waterproofing manufacturers and products and ensure your waterproofer or tiler uses one of these products). Ensure waterproofing is applied down walls, over the tile tray and into the channel and waterproof flange.

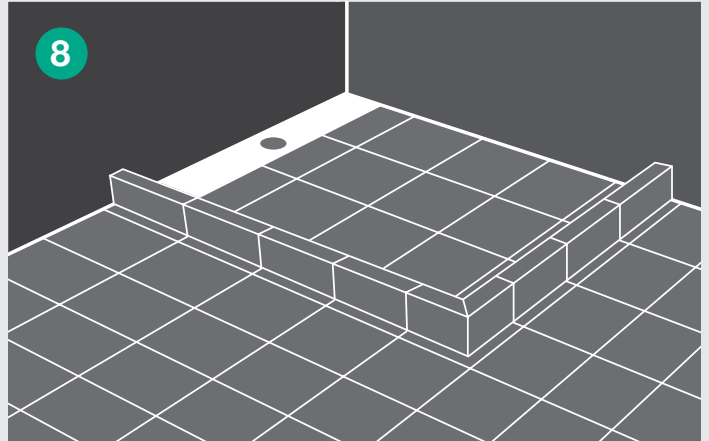

The ProFinish™ Wedge Tile Tray is now ready for tiling.

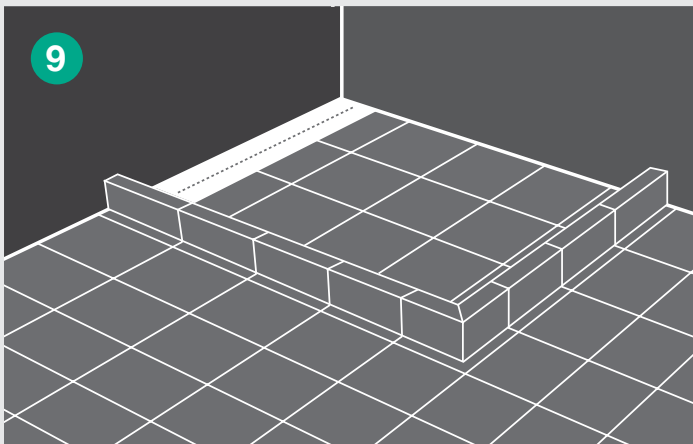

The Newline Channel Drain is installed into the recess area created by the Packer. Door and glass installation: In most cases Newline is able to provide a list of companies who can install your Newline Glass Door Set.

**PLEASE NOTE:** For recessed application, please refer to page 14 for guidance on how to calculate the recess cut out prior to installing. Tray must be fully supported by substrate. Please refer to the detailed installation instructions enclosed with your ProFinish™ product.

Comprehensive instructions are included with each tile tray package.

**Bonding options:** Refer to page 10

### Channel Drain Template\*

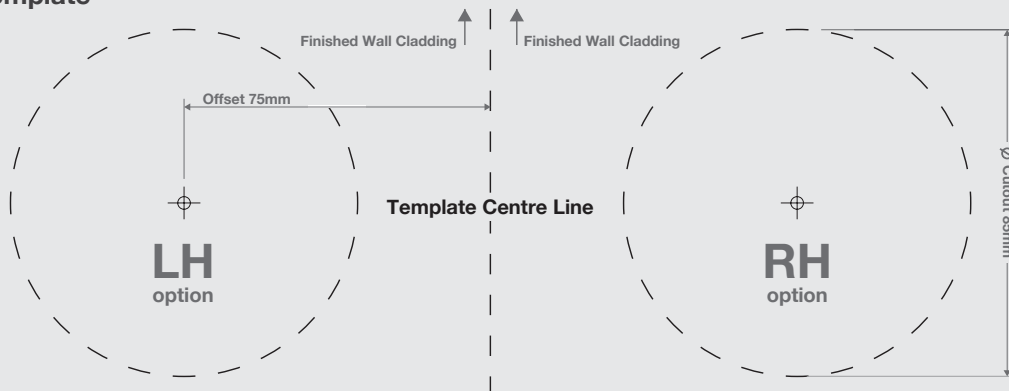

\*This Template is not to scale, use the template that comes with channel drain kit.

# Jigsaw Tile Tray System

## About

The ProFinish™ Jigsaw Tile Tray System has been designed to enable tradespeople and experienced DIY'ers to customise a tray on site with speed and accuracy. The components are made from the same material as the ProFinish™ Tile Tray, and form a tile base by being butt joined and glued together to achieve the tray size and shape required. When glued to the floor the components provide an even slope for waterproofing and tiling over. Components will form trays with either a 60 x 60mm hob or for recessed application. The Jigsaw components are designed to create a tray for use with a standard tile waste, and the Wedge components are designed to fit a channel drain.

## Custom Size, Shape, Waste Position and Hob Height

The Jigsaw Tray System comprises of three core components; the tile base, slope extension and hob (TILEBASE, SLOPEEXT and TILEBASEHOB). These can be matched in a number of flexible configurations to form a customised ProFinish™ Tile Tray for use with a standard tile waste.

- Tilebase 1, 12 & 15 are supplied as two parts per box
- Slopeext 1, 12 & 15 are supplied as one per box.
- Tilebase HOB60 supplied as one per box.

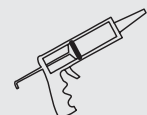
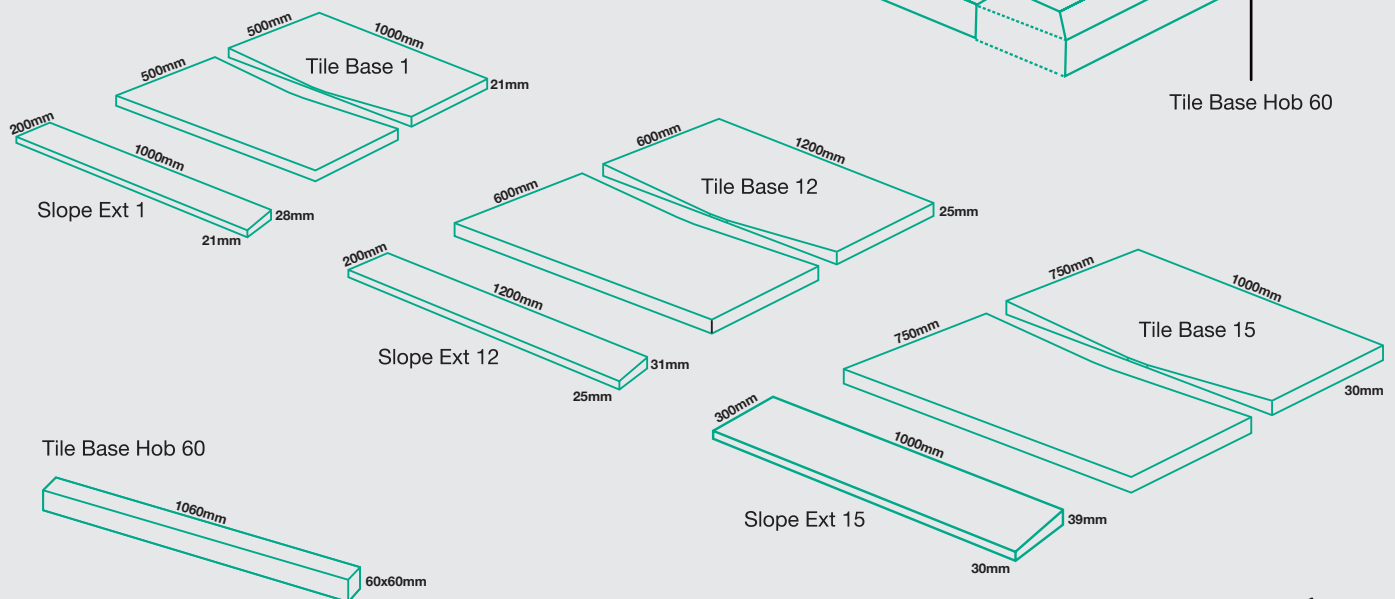
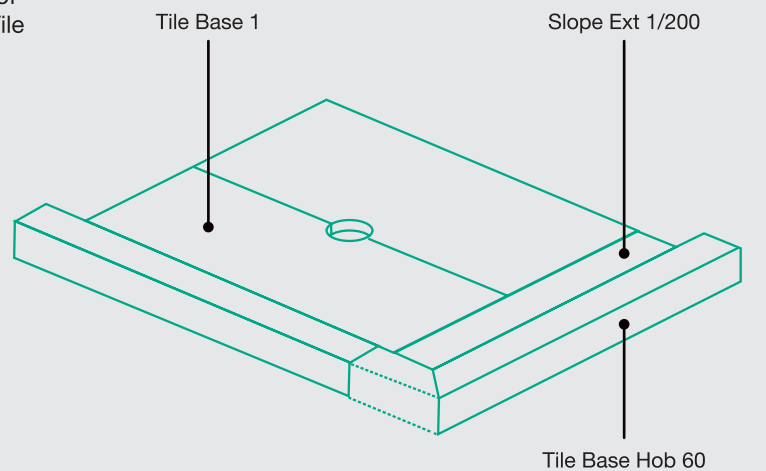

**Bonding options:** Refer to page 10

COMPONENT	CODE	DESCRIPTION
Tilebase 1		1000mm X 1000mm x 21mm
Tilebase 12		1200mm X 1200mm x 25mm
Tilebase 15		1500mm X 1000mm x 30mm
Slopeext 1		1000mm X 200mm; 21mm ▶ 28mm
Slopeext 12		1200mm X 200mm; 25mm ▶ 31mm
Slopeext 15		1000mm X 300mm; 30mm ▶ 39mm
Tilebase Hob 60		1060mm x 60mm x 60mm



## What Part Shall I Order?

The Jigsaw components needed to form your tile base are determined by the position of your shower waste, and the dimensions of your shower.

1. Install the waste flange into its correct position.
2. Measure from the centre of the waste to the side walls and from the centre of the waste to
3. The outside perimeter to establish tray dimensions.
4. Using these measurements, determine which tile base you will require, if you will require
5. The matching slope extension, and how many hobs.

## Example One

### Tray specification:

2 sided tray 1000mm x 1000mm, waste position 300mm x 300mm with hobs.

### Required components:

- 1 x Tilebase 1 (1000mm x 1000mm)
- 2 x Slopeext 1 (1000mm x 200mm)
- 2 x Tilebase HOB 60 (1060mm x 60mm x 60mm)

### Please note:

- Because hobs are being used the tray must be cut 60mm smaller than the required size (i.e 940mm x 940mm) to compensate for the use of the TILEBASEHOB 60.
- To accommodate the non centre waste position (300mm x 300mm) trim both wall adjoining sides by 200mm (500mm - 300mm waste position = 200mm). By trimming 200mm off both sides you are left with a tray of 800mm x 800mm with waste position 300mm x 300mm.
- Trim both SLOPEEXT 1 by 60mm on both sides, place on the front non-wall adjoining sides by cutting the corner at a 45 degree angle and butt joining.
- Tray now =  $(800 + 140) \times (800 + 140)$  940 x 940
- Cut and add the 2 x TILEBASEHOB 60

1. Components

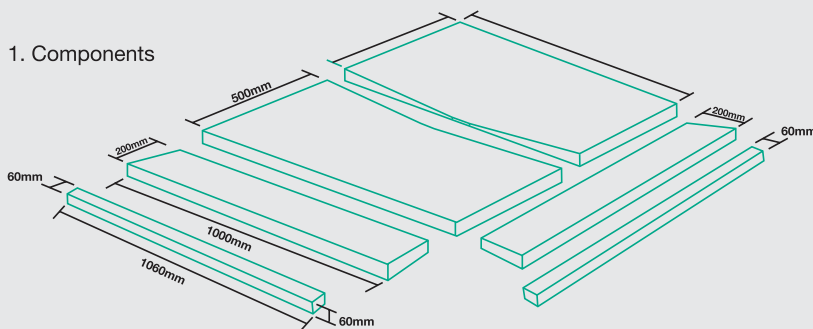

2. Trim

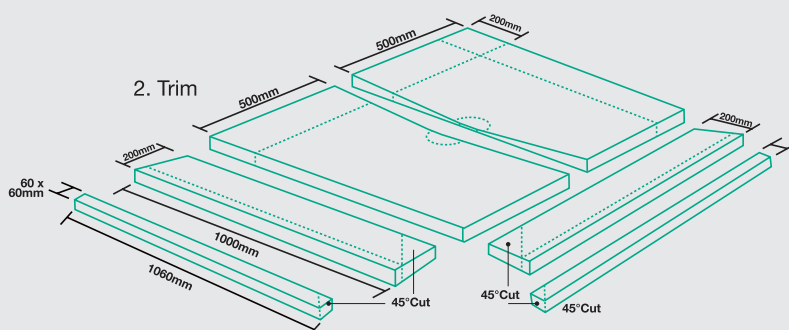

3. Final

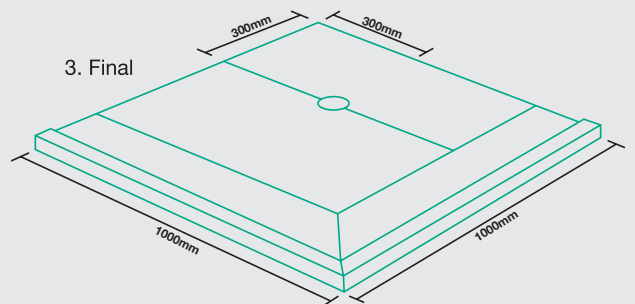

# Jigsaw Tile Tray System - Continued

## Example Two

### Tray specification:

2 sided tray 1000mm x 1000mm; waste position 250mm x 250mm recessed.

### Required components:

- 1 x Tilebase 12 (1200mm x 200mm)
- 2 x Slopeext 12 (1200mm x 200mm)

#### 1. Components

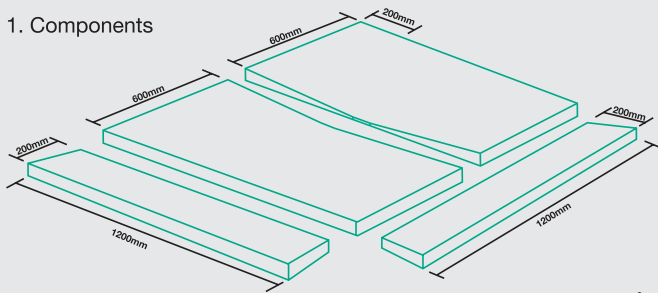

#### 2. Trim

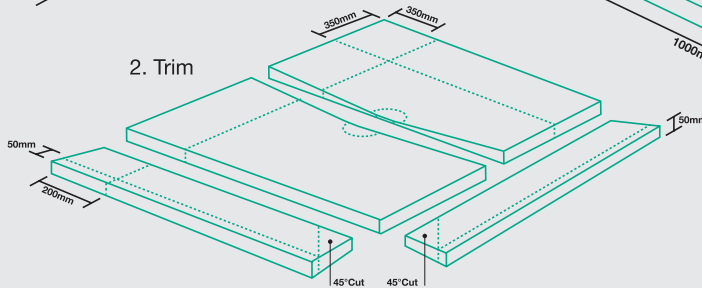

#### 3. Final

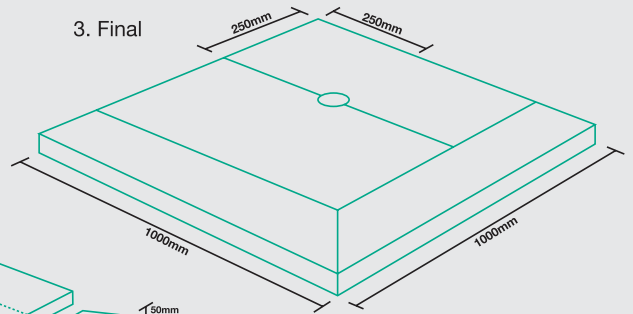

### Please note:

- To accommodate the non centre waste position (250mm x 250mm); trim both wall adjoining sides by 350mm (600mm - 250mm waste position = 350mm). By trimming 350mm off both sides you are left with a tray of 850mm x 850mm with waste position 250mm x 250mm.
- Trim both Slopeext 12 by 50mm on the long sides and 200mm at the short sides. Cut and join at a 45 degree angle.
- Tray is now 1000mm x 1000mm.

## Example Three

### Tray specification:

2 sided tray 960mm x 1480mm with centre waste and hobs

### Required components:

- 1 x Tilebase 15 (1500mm x 1000mm)
- 3 x Tilebase Hob 60 (1060mm x 60mm x 60mm)

#### 1. Components

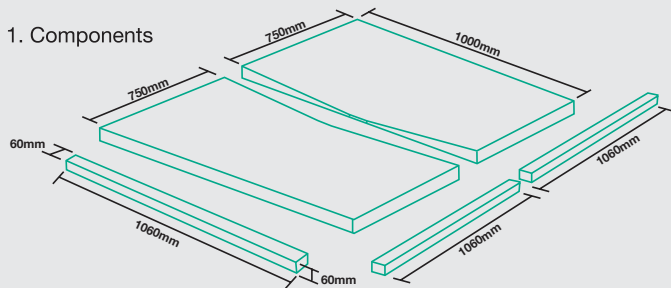

#### 2. Trim

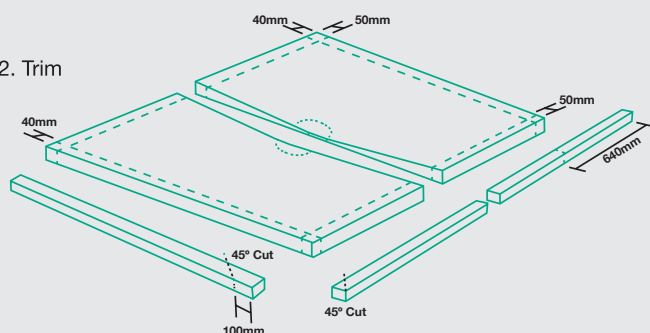

### Please note:

- Because hobs are being used the tray must be cut 60mm smaller than the required size (900mm x 1420mm) to compensate for the use of the Tilebasehob 60.
- To ensure waste position remains in the centre trim 40mm off each side (1500mm - 40mm - 40mm = 1420mm); and trim 50mm off the front and back sides (1000mm - 50mm - 50mm = 900mm).
- Trim and join the 3 x Tilebasehob 60 to complete the tray specification 960mm x 1480mm. Hobs joining at the corner should be cut to meet at a 45 degree angle.

#### 3. Final

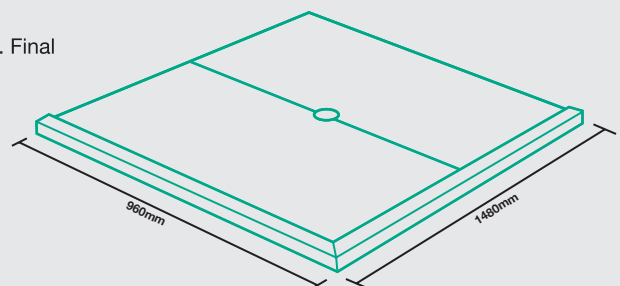

# Jigsaw Tile Tray System – Wedge Components

## About

The Wedge Tray System comprises three different sized wedge components that can be joined to form a customised ProFinish™ Wedge Tile Tray for use with a channel drain.

The three core sizes are staged 5mm to 21mm; 21mm to 37mm and 37mm to 53mm so that they can be joined to provide a continuous slope to channel drain waste.

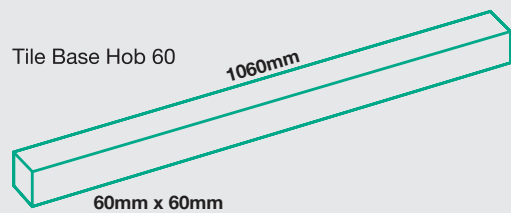
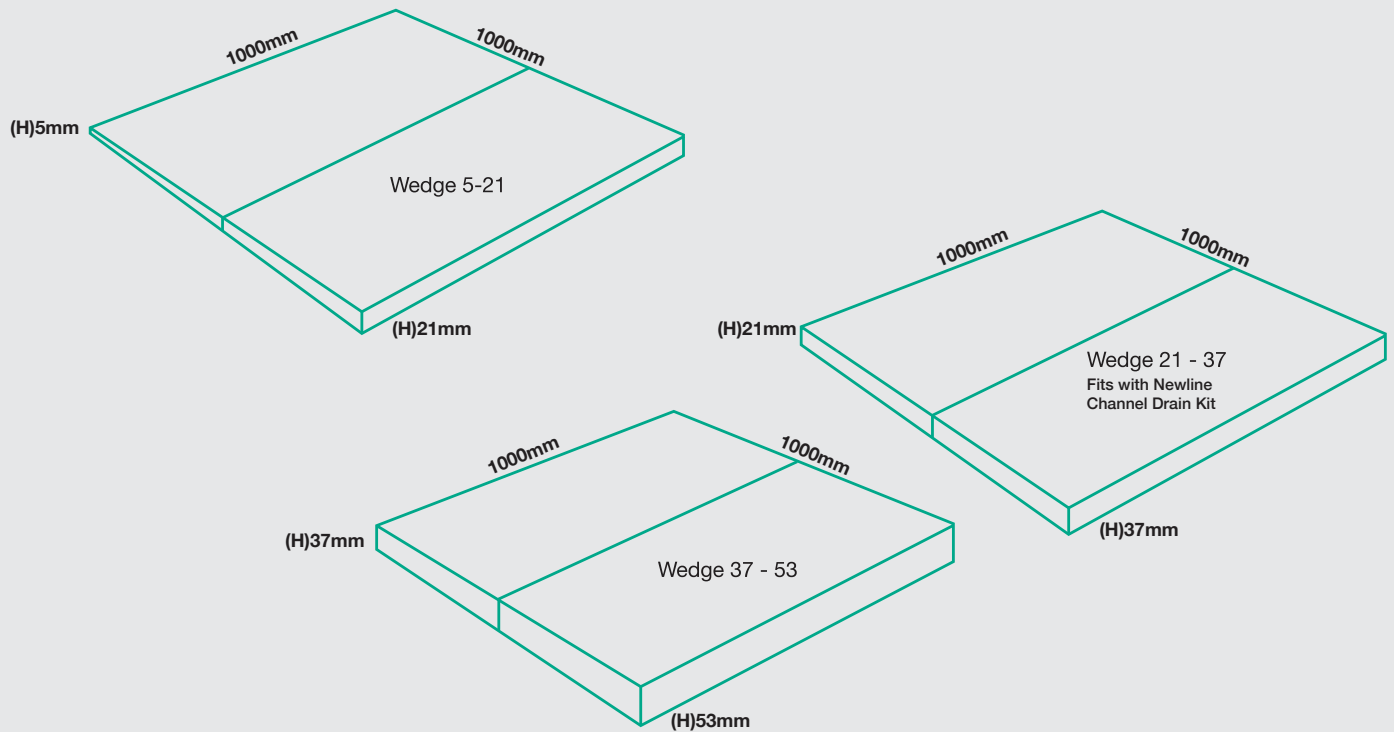

Component	Code	Description
WEDGE 5 - 21		1000mm X 1000mm; 5mm increasing to 21mm*
WEDGE 21 - 37		1000mm X 1000mm; 21mm increasing to 37mm*
WEDGE 37 - 53		1000mm X 1000mm; 37mm increasing to 53mm*
TILEBASEHOB 60		1060mm X 60mm X 60mm

\*These parts are supplied in two halves.

# Barrier Free Floor System



## Suitable for Tile or Vinyl Overlay

Ideal for disabled and wheelchair access bathrooms, the ProFinish™ Barrier Free Floor System provides an innovative customisable solution for barrier-free continuous fall to waste.

In addition, it is particularly well suited for wet area bathrooms where there are no glass surrounds to direct water flow yet a continuous fall to waste slope is required.

The ProFinish™ Barrier Free Floor System shares all of the features and benefits of the ProFinish™ Tile Tray System. It is custom designed and manufactured by Newline from the same rigid polyurethane, and like the tile tray, simply glues to the floor.

## The ProFinish™ Barrier Free Floor System is commonly used for:

- Flat areas under the toilet and by the vanity
- Ramps at the entry to the shower area and/or room (instead of the standard hob).
- Any situation where minimal disruption is advantageous.

The ProFinish™ Barrier Free Floor System is suitable for both tile and vinyl overlay. If vinyl is to be applied, a fibreglass membrane must be applied at time of manufacture for added strength.

## Please note:

If a ProFinish™ base is to be used on a concrete substrate then covered with a vinyl overlay, the end of the base must be feathered with a leveling compound.

# Options for the Barrier Free Floor System

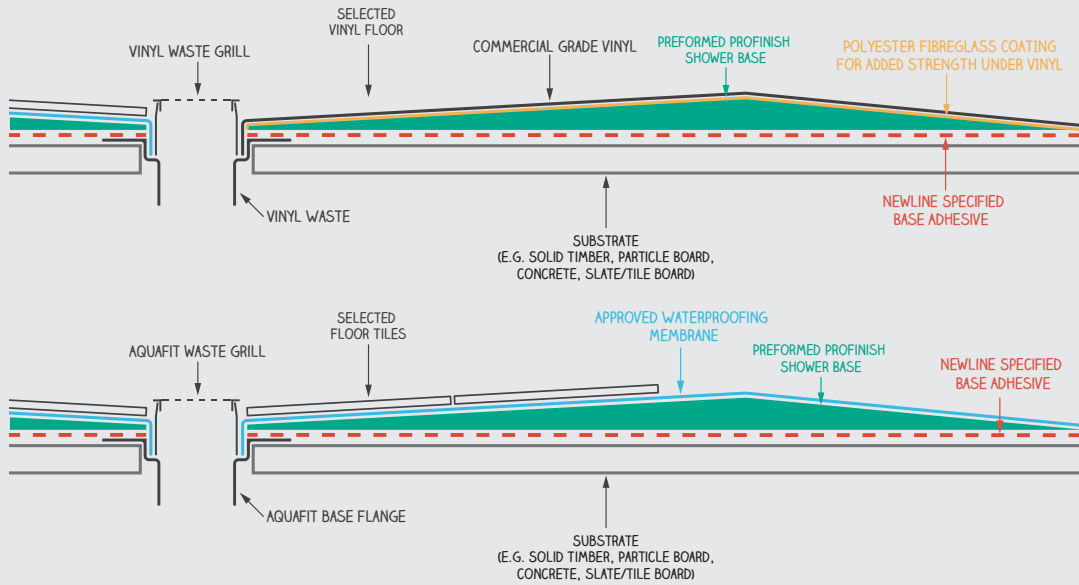

## Example 1

The ProFinish™ Barrier Free Floor System is used for the shower area only and meets the existing floor at a height of 5mm.

## Example 2

The ProFinish™ Barrier Free Floor System covers the entire 2000 x 2000 bathroom with a ramp at the entrance and flat area bathroom then fall to waste.

## Example 3

The ProFinish™ Barrier Free Floor System covers the entire 1800 x 1600 bathroom, with slope from the doorway to waste.

The experienced Newline team will work with you to provide a bespoke solution to meet your needs. Simply highlight your requirements by completing the form on page 25.

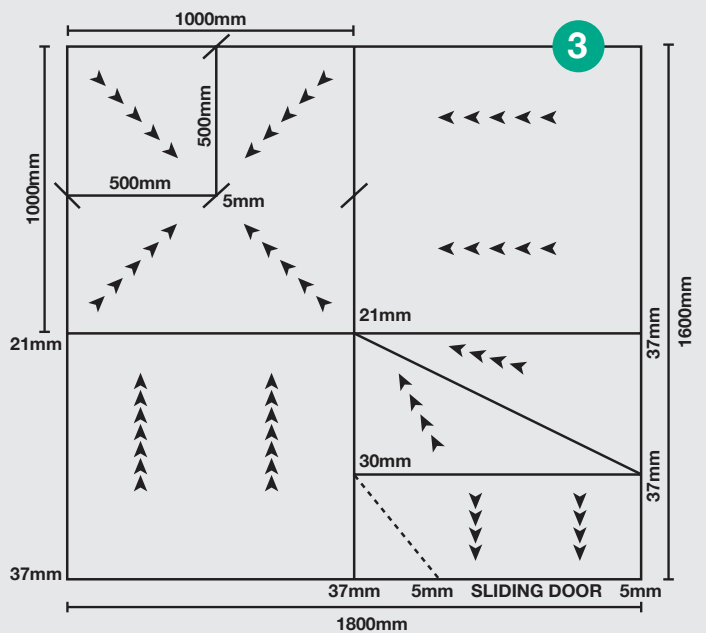
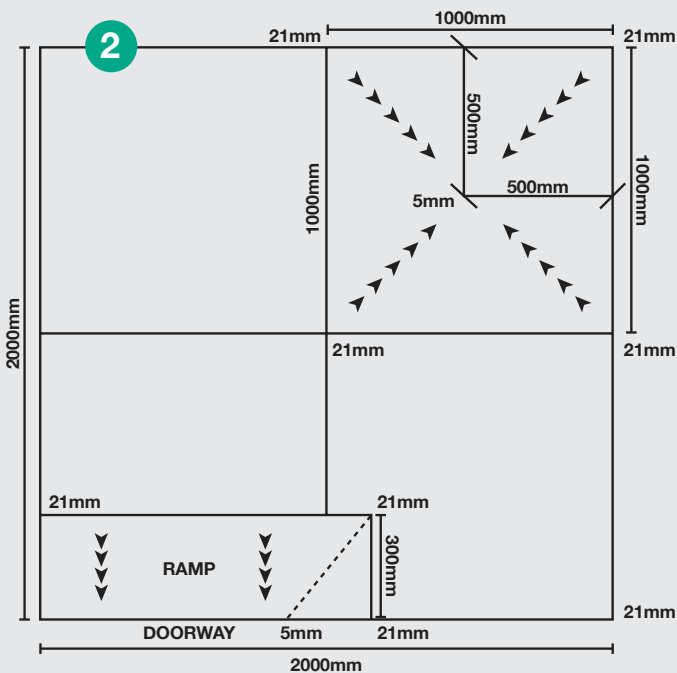
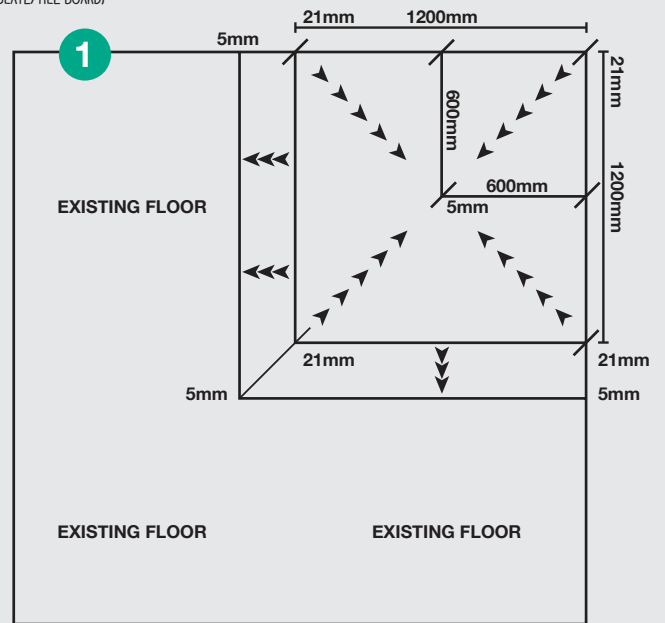

# Recessed Tile Shelf



## FEATURES:

**Easy to use**  
Ready to be installed

**Standard depth**  
87mm unfinished

**NZ Made**  
Light weight, rigid polyurethane

**Tested and compatible**  
with waterproofing systems

## SIZES:

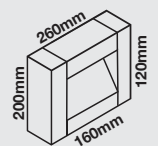
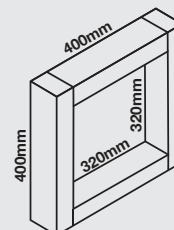
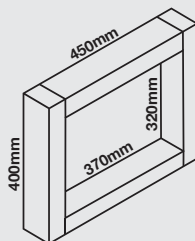
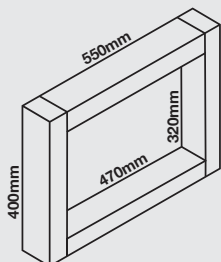
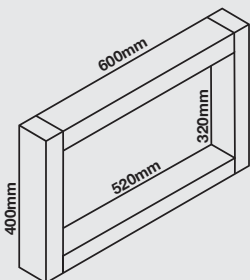

Foot shelf

Custom options available

All measurements nominal and for unfinished shelf

# Tile Wastes Channel Drain

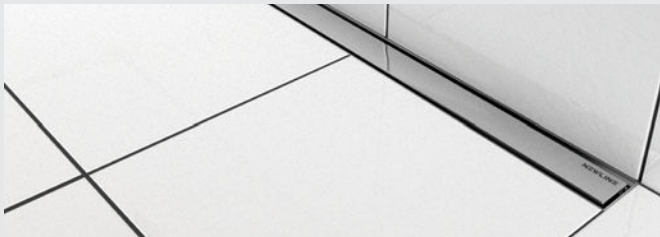

Stainless steel option



Tile insert option

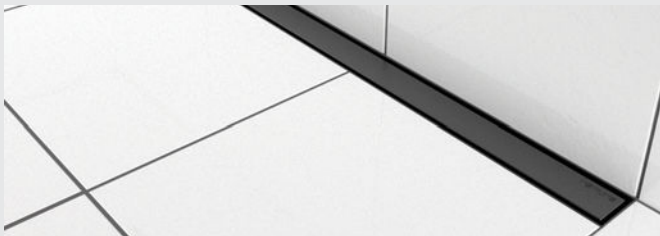

Black option (custom)

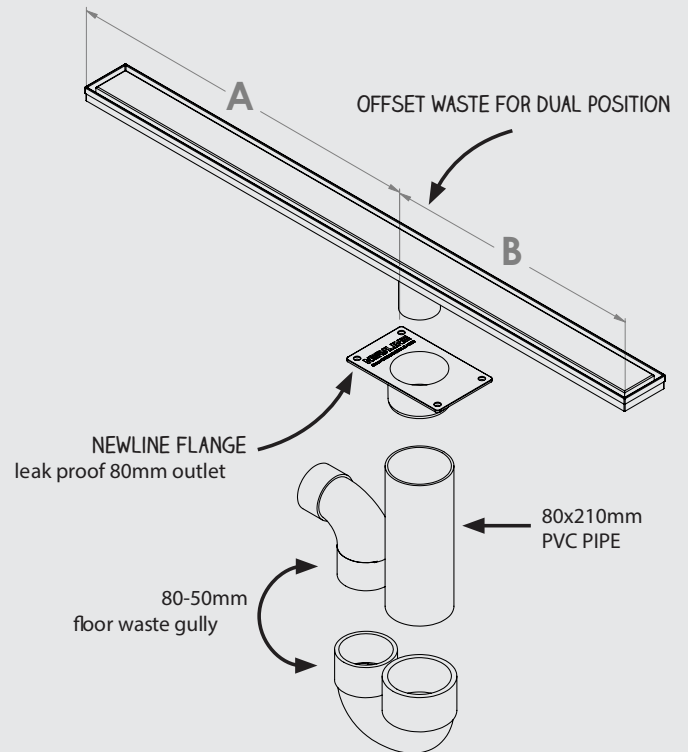

Offering a sleek minimalistic approach to your stylish tile shower. Designed for everyday living, yet easy to access and clean. Available in high quality stainless steel cover, or a tile insert cover. Newline now also offers a customised black finish to match your decor.

## Features:



### Slimline Design

A slim 70mm profile that creates sleek minimalistic design to your shower.



### Unique Fitting Channel

Can be fitted flush against wall.



### High Quality

Our channel drains are made with 316 marine grade stainless steel, known for its strong resistance to corrosion and adds stylish durable touch to your shower.



### Fast Water Drainage

Designed with an increased fall to the outlet for fast water drainage.



### Reversible

Reversible channel insert for a stainless steel or tile insert option.

Model	Stainless Code	Black Code	L X D X H	Offset A	Offset B
Channel Drain 710	CHA0728	CHA0803	710 x 70 x 23	430mm	280mm
Channel Drain 810	CHA0735	CHA0810	810 x 70 x 23	480mm	330mm
Channel Drain 910	CHA0742	CHA0827	910 x 70 x 23	530mm	380mm
Channel Drain 1110	CHA0674	CHA0759	1110 x 70 x 23	630mm	480mm
Channel Drain 1310	CHA0681	CHA0766	1310 x 70 x 23	730mm	580mm
Channel Drain 1510	CHA0698	CHA0773	1510 x 70 x 23	830mm	680mm
Channel Drain 1710	CHA0704	CHA0780	1710 x 70 x 23	930mm	780mm
Channel Drain 1910	CHA0711	CHA0797	1910 x 70 x 23	1030mm	880mm

# Tile Wastes Centre Waste



## Newline tile waste kit

80mm or 100mm  
Grate options

**Chrome Grate**  
Contemporary design

200mm Depth  
Below substrate

**Custom Black Option**  
Contact customer service for  
more information



## Newline easy clean tile waste

50mm Outlet  
Adjustable inlet

**S/Steel Grate**  
Removable

100mm Depth  
Below substrate

**Tile And Vinyl**  
Options available

Product	Description	Size	Code
<b>NEWLINE TILE WASTE KIT</b>	Includes SQ CP Grate, Leak Control Flange, Riser and Trap	80mm	L7744
	Includes SQ CP Grate, Leak Control Flange, Riser and Trap	100mm	L7737
<b>NEWLINE EASYCLEAN TILE WASTE KIT</b>	Easyclean tile waste	50mm	L7713
<b>VINYL WASTE KIT</b>	Vinyl shower waste kit	50mm	L7706



# Tile Tray Waterproofing

- The Independent Waterproofing Companies listed below have tested their systems and procedures on Newline Profinish Tile Trays. This represents years of proven track record.
- At the time of publication all Waterproofing Systems hold a BRANZ Appraisal.
- All the Waterproofing Systems listed have an aligned Tiling Systems. You must use the associated Waterproofing & Tiling system for compatibility, performance and accountability.
- A Producer Statement must be provided to the Council Authority and Owner detailing the Waterproofing applicator ID or Code. As an appendage also include the tiling system utilised.
- Applicators must be trained and hold current Accreditation with the respective system being utilised for the Warranty to be valid. We advise you to ask for these credentials.

COMPANY	PRIMER	PRODUCTS	CONTACT	WARRANTY
<b>ARDEX</b>	Prep: Wipe down with damp cloth - No primer	1. ARDEX WPM 155 Rapid (1 Part Poly- Acrylic) 2. Ardex Superflex WPM 002 (2Part) 3. ARDEX WPM 750 WeldTec Undertile Sheet Membrane*	Ronald Rose 027 838 5691 ronald.rose@ardexnz.com	15years  *20years
<b>DAVCO Tilemax Ltd</b>	Davco Primex	1. Davco K10 Plus - Polyurathane (Coat Primex within 24 hrs) 2. Davco K10 Rapid	Isaac Gordan 022 127 7694 isaac@tilemax.co.nz	15 years
<b>DRIBOND CONSTRUCTION CHEMICALS</b>	Primax Bonding slurry - Kemcrete mixed 50/50 with cement or Gripflex	1. Hydrathane 2. Liquid Flash 2- Pack 3. Reomat b/breaking Tapes	Steve Plester 022 1205416 sp.conchem@xtra.co.nz	15years
<b>LADICRETE GLOBAL TILE</b>	Prep: as instructions No Primer	Hydro Ban SBR	Chris Anderson 021 784 162 Chris@globaltile.co.nz	15years
<b>MAPEI</b>	Ecoprim Grip (1part) Magelastic SP (2 part)	1. Mapelastc AquaDefence 2. Mapegum WPS 3. Mapelastc Smart (2part)	Heidi Clark 027 6455 122 heidi.clark@mapei.co.nz	15 years
<b>SIKA (NZ)</b>	Per Instructions	Sikalastic-152	Andy Williams 09 820 2900 021 421 084 williams.andy@nz.sika.com	15 years
<b>Tiling Trade Supplies T/A Technokolla NZ</b>	Prep: Clean and Vac surface. Technokolla 101	1. Technokolla RL80 SeamTape joins Rasolastic Advance. Two Part 2. Strataflex & Rasogum over laps	Dave Boyes 0275 635 891 dave@technolla.co.nz	15 years

- Newline warrants the performance and integrity of the Profinish Tile Shower Base for 20 years. Non-conformity to installation instructions has the risk of failure.
- All Waterproofing and Tile Installation must be installed as per manufactures Specifications as any deviation from the instructions may result in a performance failure.
- All Tiling must follow BRANZ Good Tiling Practice.



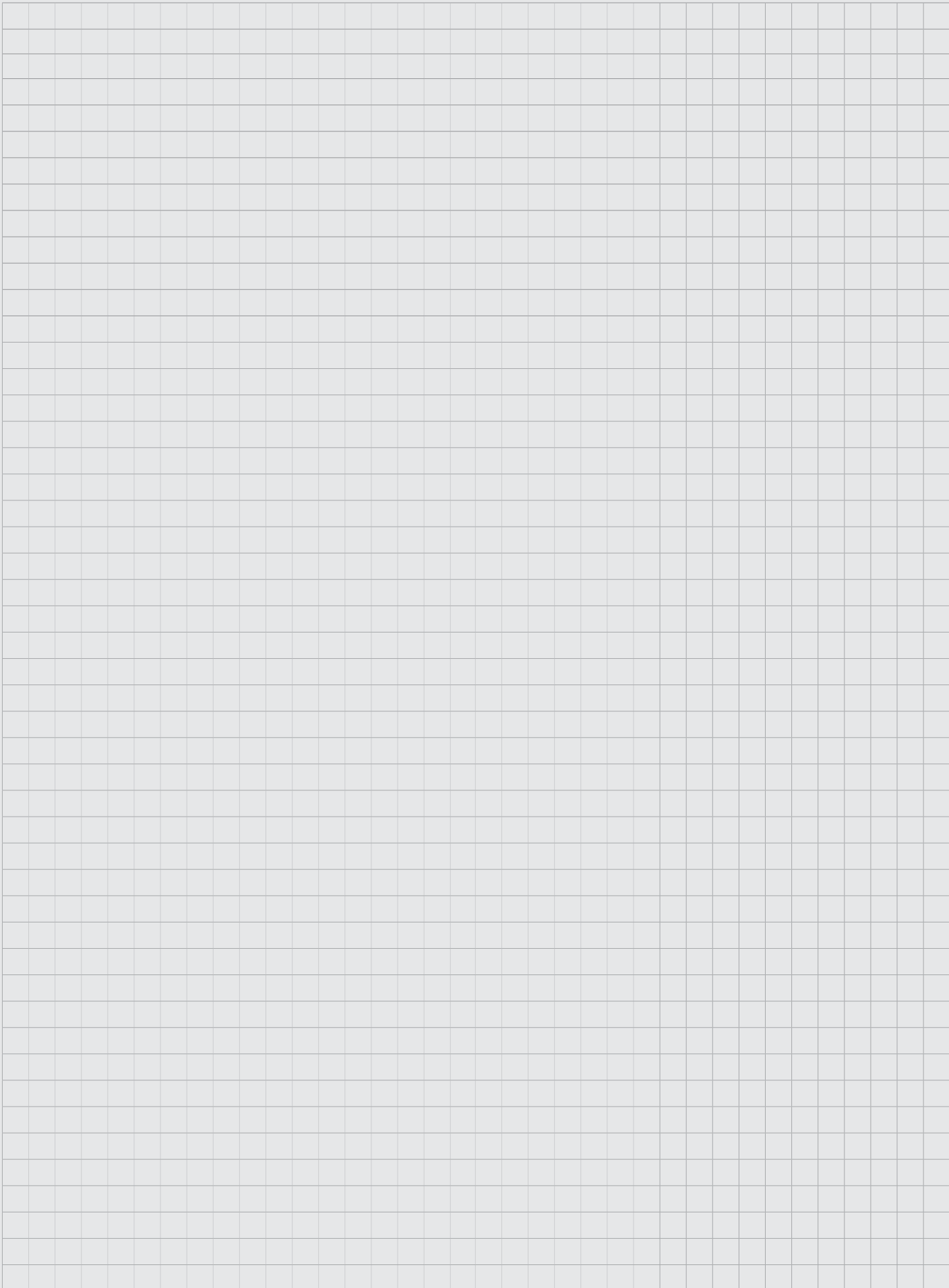



**HEAD OFFICE:**

Freephone: 0508 639 5463 | Phone: 09 444 2053

Fax: 09 443 0044 | [info@newline.co.nz](mailto:info@newline.co.nz)

[newline.nz](http://newline.nz)