

Important

1. When you receive your product check the contents for any freight damage or defects.
2. If this is a custom order, the size will be on the outside of the box. Check that it is correct.
3. Advise Newline on 0508 639 5463 if any damage has occurred or if you have any questions about the size within 8 hours of receiving the goods so this can be rectified.
4. Do not install faulty products, as this will void your warranty.

BEFORE YOU START

Newline provides full Specification Documents for two Categories of Showers.

WAIT

- **Before you start** please read through the pre-install guide that applies to this project.

Acrylic Pre-Install Specifications

Tile Pre-Install Specifications

HEALTH AND SAFETY



- **Unpack glass**, stand on soft packing on floor and walls prior to assembly.
- **Do not** rework glass panels.
- **Do not** strike an edge or corner of glass.
- **Use two persons** where heavy glass lifting is required.
- **Wear appropriate** protective clothing and eye protection during installation.
- **Mark gas/water pipe** and electrical wire locations to ensure these are not touched.

ATTENTION



- **The tray base** must be installed level as this affects all shower alignments.
- **Wall Specifications** require a max variation of 3mm within shower height. Installer must check the viability of install if outside of these specs.
- **3-Sided Alcove Showers:** Wall must be accurate, straight, and plumb. Refer pre-install guide.
- **Double studs for solid fixing of wall channels:** Positioned at tray outside edge and inwards so all shower configurations have the support required.
- **The Installers Responsibility:** The installation must comply with all council regulations.

Tools Required

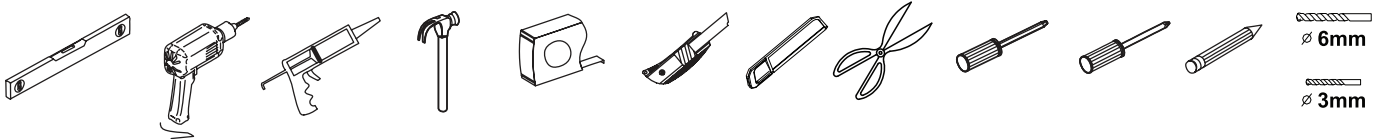

WARRANTY

- This covers faulty goods but not breakages. Visit newline.nz for information.
- Compliance with Specs and these instructions are essential for a valid warranty.

NEWLINE RECOMMENDS A SKILLED TRADESMAN ACQUAINTED WITH SHOWER INSTALLATIONS TO ENSURE THE VERY BEST OUTCOME.

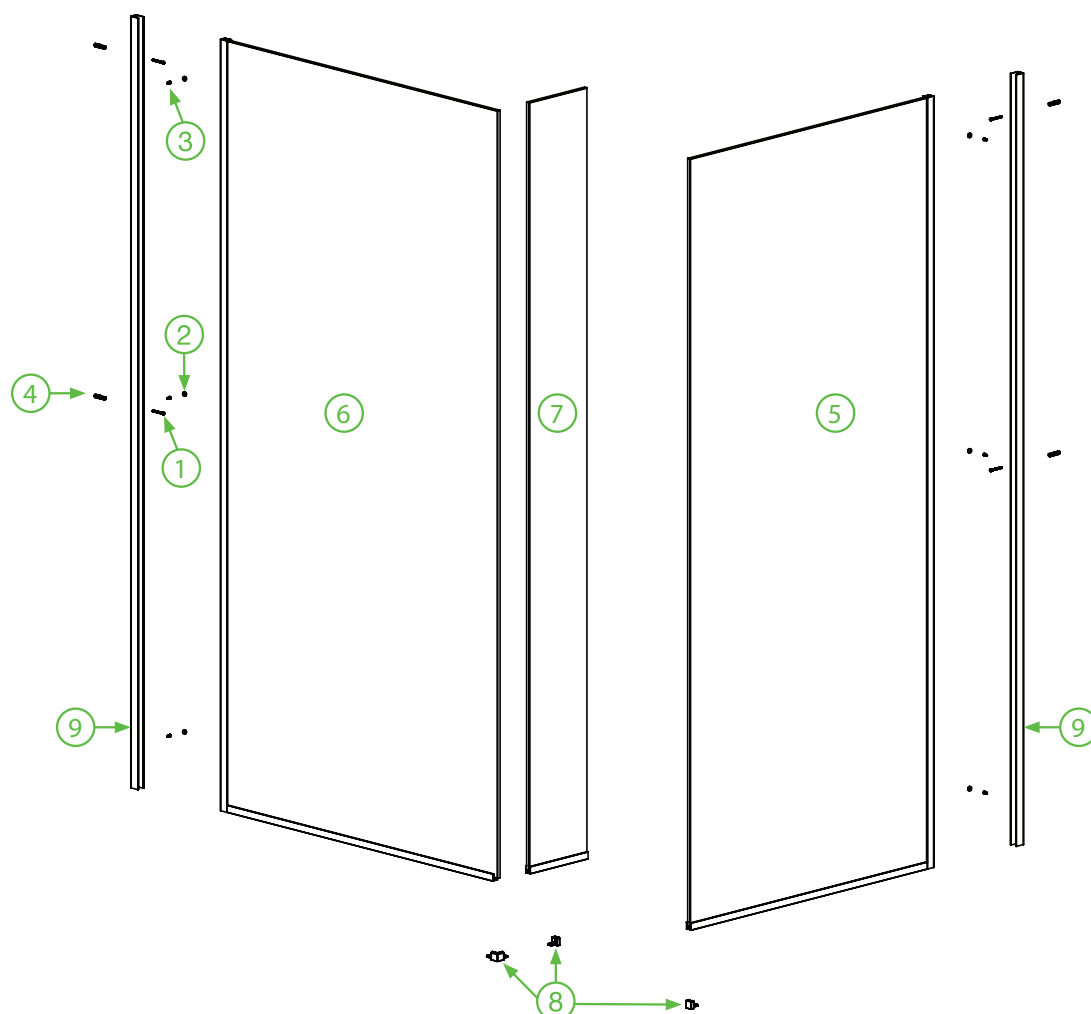

COMPONENTS LIST

REFERENCE	DESCRIPTION	PART NUMBER	QUANTITY
1	6 Gauge x 12 sq screws	Fastening Screw Pack	8
2	6 Gauge x 40mm screws		6
3	Screw caps		8
4	Wall plugs		6
5	Large return glass panel		1
6	Fixed front glass panel		1
7	Small return glass panel		1
8	Clip Pack		4
9	Wall profile	A1887	2

2-Sided: Includes all panels

3-Sided: Excludes large return

- Use Diagram A to set out glass panels.
- Mark and plumb up the outside of wall profiles.

Refer to Minimum to Maximum Table below for standard sizes

DIAGRAM A

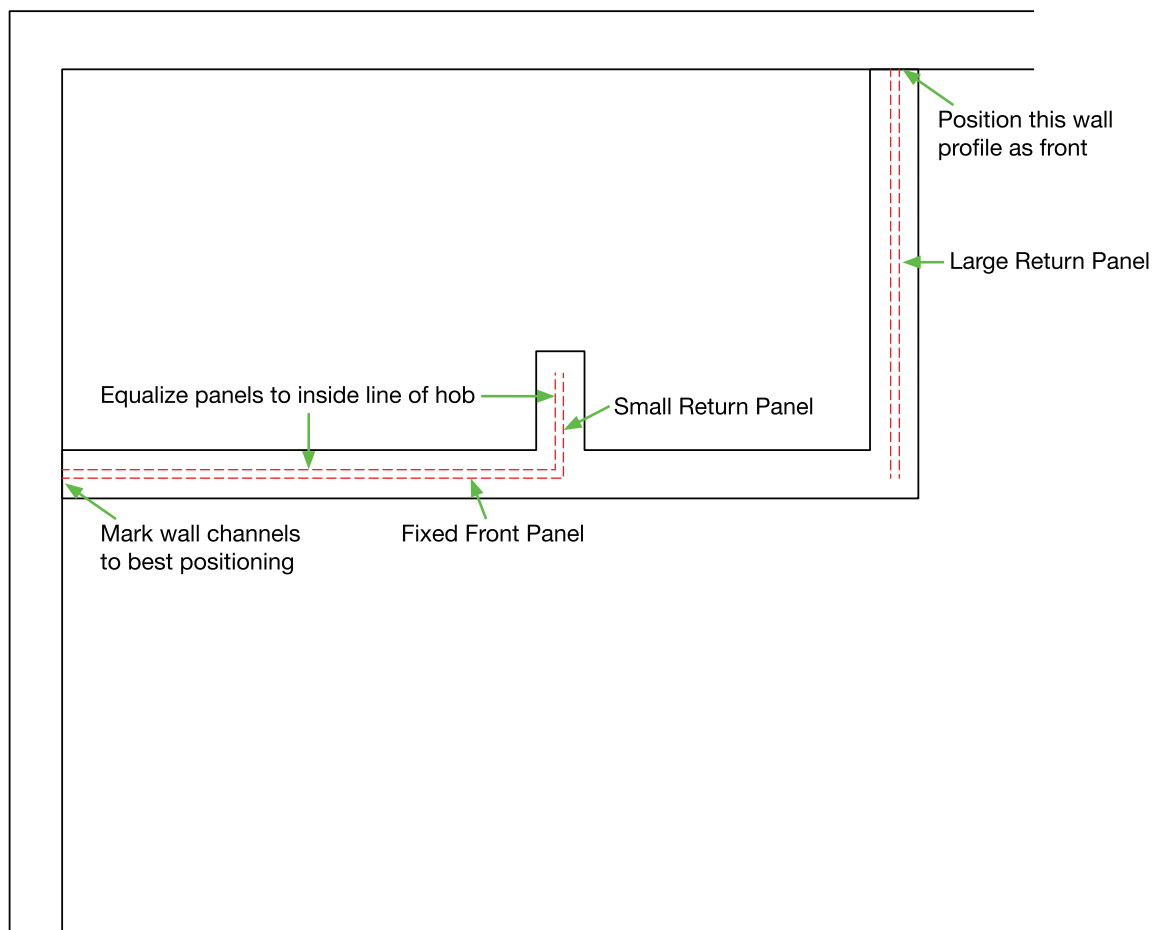

TILE TRAY SIZE

GLASS PANELS MINIMUM TO MAXIMUM

ProFinish Tray	Fixed Front Glass ⑥	Small Return Glass ⑦	Large Return Glass ⑤
1660x900 2Sided	964mm - 976mm	200mm	844mm - 856mm
1760x900 2 Sided	1064mm - 1076mm	200mm	844mm - 856mm
1600x900 3 Sided	964mm - 976mm	200mm	N/A
1760x900 3 Sided	1064mm - 1076	200mm	N/A

All Custom Walk-In Showers will be marked on the outside of packaging.

1

- Install wall channels at marked positions with Bostik V60, apply pressure to channel, tape in place, clean off excess silicone and allow to cure (Refer to curing below).

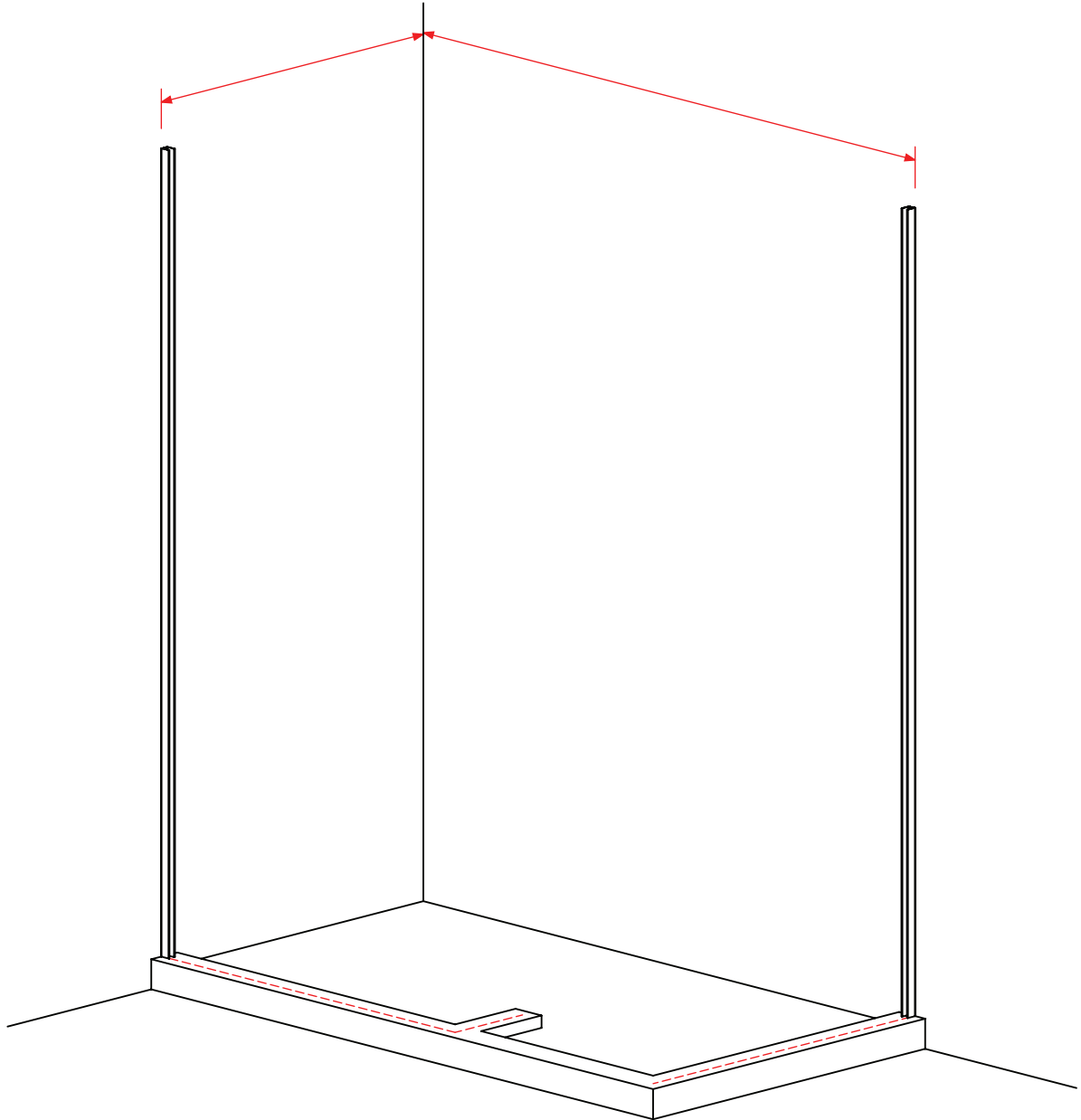

PENETRATION OF WATERPROOFING UNDER TILES

Waterproofing warranties are potentially void with penetrations of membrane. Bond wall profiles with Bostik V60. Minimum curing 24 hours (2mm to 3mm). Curing is by atmospheric moisture absorption (approx. 7mm in 7 days).



3

- Fit up the small Return Glass panel (7). Leave the backing tape on the adhesive strip and check alignment to the corner bracket and glass fit at corner.
- Clean the Glass face where the adhesive will bond with Meth's or Isopropyl Alcohol. With the assistance of a second person, remove the backing tape and carefully align the small Return Glass starting from the bottom and work up.
- Use the plastic fast action clamps and apply pressure to fully activate the bond (work up and down the join applying pressure with clamps).
- Line up Small Return Glass (7) hold in place with adhesive blocks.
- Inject silicone under end of floor channel to bond to tiles and fit end clip.

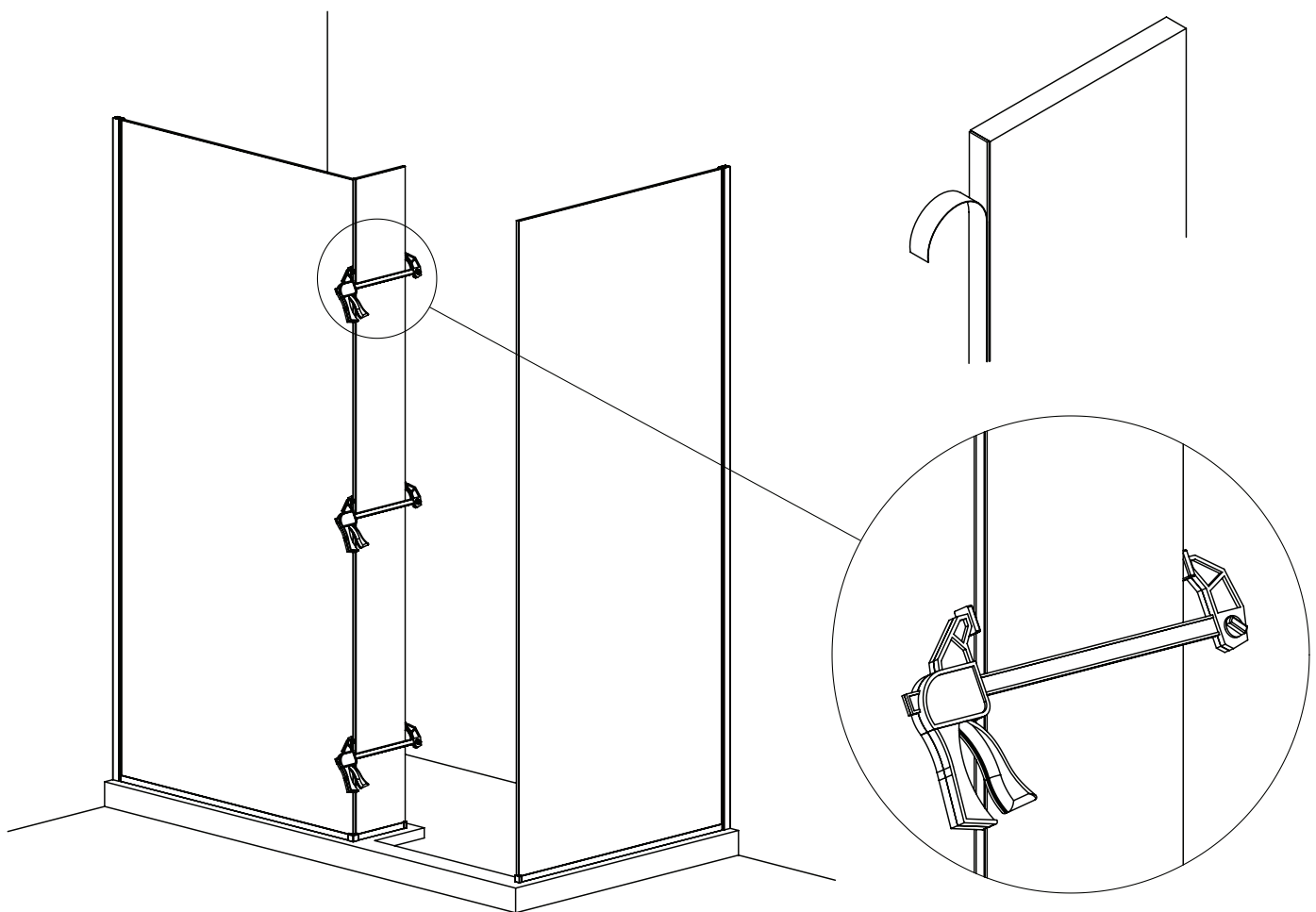

4

- Fasten shower screen to wall channels with 3 short screws provided and fit screw caps.

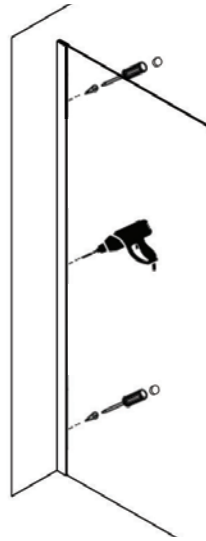

5

- Apply silicone as indicated in Diagram. Clean up excess.
- Leave for 24 hrs for curing of silicone.

